

DANCAR CRUISE CONTROL

Fitting instruction Steering wheel command for DUCATO BOXER JUMPER

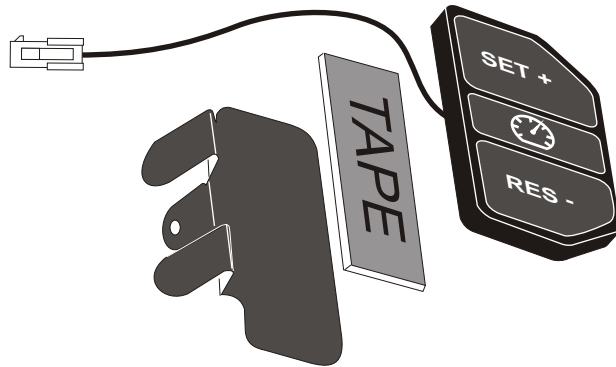

User instruction: Included

Partnumber: SW-11

JKH203GB V2

Copyright: DanCar.dk

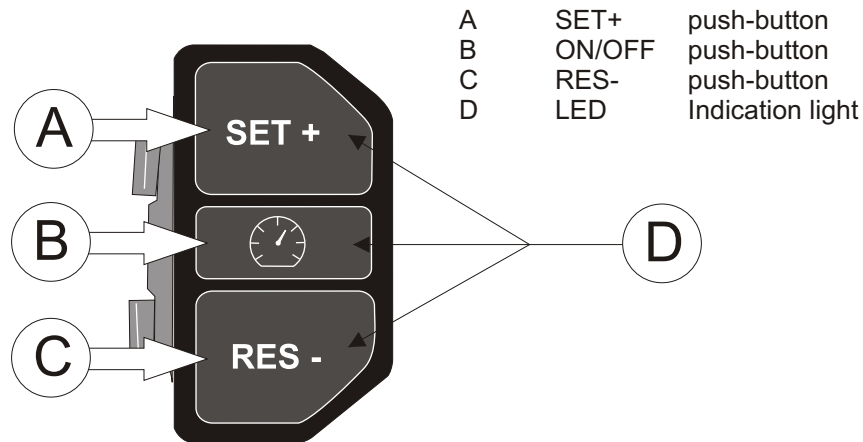

To activate the system

Turn on the ignition (dim light (D) comes on) and push “ON / OFF“ button (B) to turn the system on. The (B) button highlight.

Storing desired cruising speed

To store your desired cruising speed press push the “Set+“(A) button. A “click” is heard from the unit. This is a safety feature. You must be travelling at a speed above 30 km/h or less than 140 km/h. The system is tested and approved at speeds between 30 km/h and 140 km/h.

The desired cruising speed is now stored and the vehicle will travel at this speed without need to use either the accelerator or the brakes.

Changing cruising speed

Each push on the “Set+” button (A) will increase the cruising speed by approx. 1 km/h. Each push on the “RES-” button (C) will reduce the cruising speed by approx. 1 km/h. If keys are hold down for more than 1 sec., the cruise speed will change until release of the button.

Using the last stored cruising speed. (Memory function)

The system remembers the last stored cruising speed until the ignition or system is turned off. This last stored cruising speed can be used at speeds over 35 km/h. Pushing the “RES-“ button will bring the vehicle to the last set speed.

Increasing speed with the accelerator

When travelling at the set cruising speed, the accelerator may be used to increase the vehicle's speed. A “click” sound is heard from unit (safety feature).

To de-activate the system

The system can be turned off by pushing the brake or clutch pedal (not with automatic gearbox), or by pushing the “ON / OFF“ button (B). When using button (B) for de-activation, the system lose the memory of last stored cruise speed and the highlight in button (B) turn into dim light.

Safety note:

To prevent possible damage to the engine from high revs, store the desired cruising speed in the gear that will be used for driving at this speed. Do never use the cruise system in congested traffic or on wet slippery road. If a situation ever arise where system will not disengage according to normal use, you can always turn the ignition to OFF. If the veichle has a steering lock, be sure it cannot be activated when the ignition key is in the ignition lock or the car is in gear.

Note: The illumination of the control unit are disabled occasionally. This is not a defect and has no safety or operational effect.

Contents

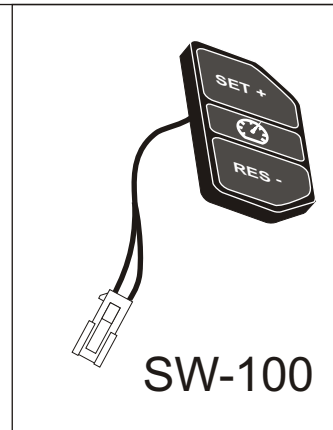
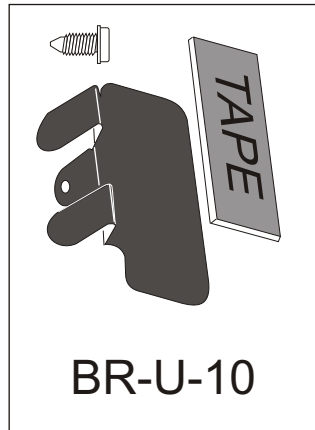
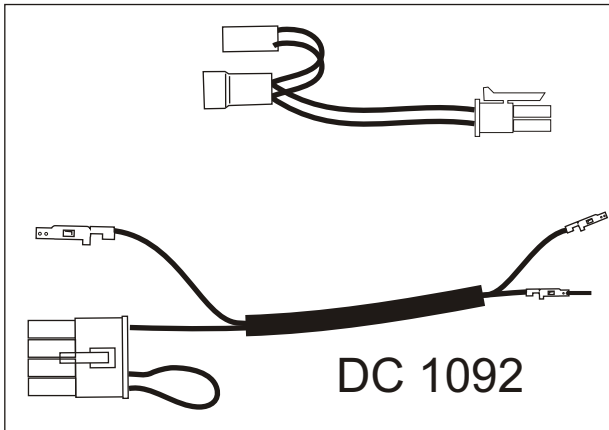

Warning:

This Steering wheel command must only be fitted on cars which have a negative horn command. Further, the horn relay must not exceed 120 mA consumption.

The Steering wheel command must be suited in a way, that ensure the original function of the steering wheel and the airbag, regarding the necessary security precautions. Fitting must only be performed by professionals who possess the necessary technical knowledge and the necessary tools.

Remove the airbag

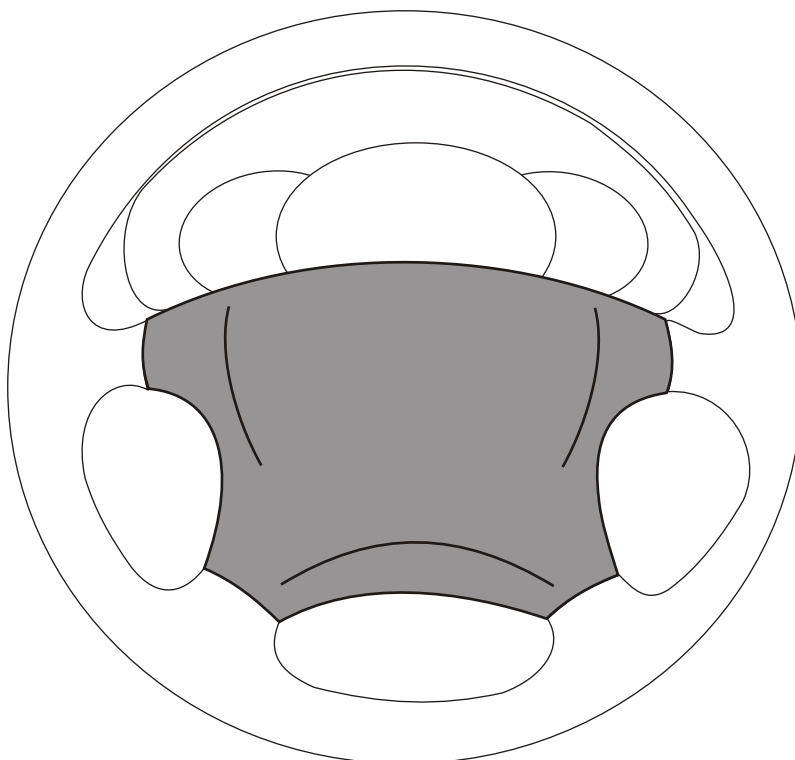

Fasten the unit

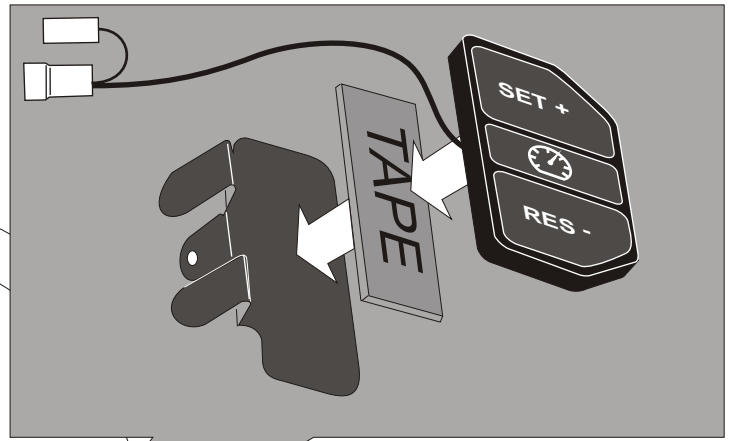
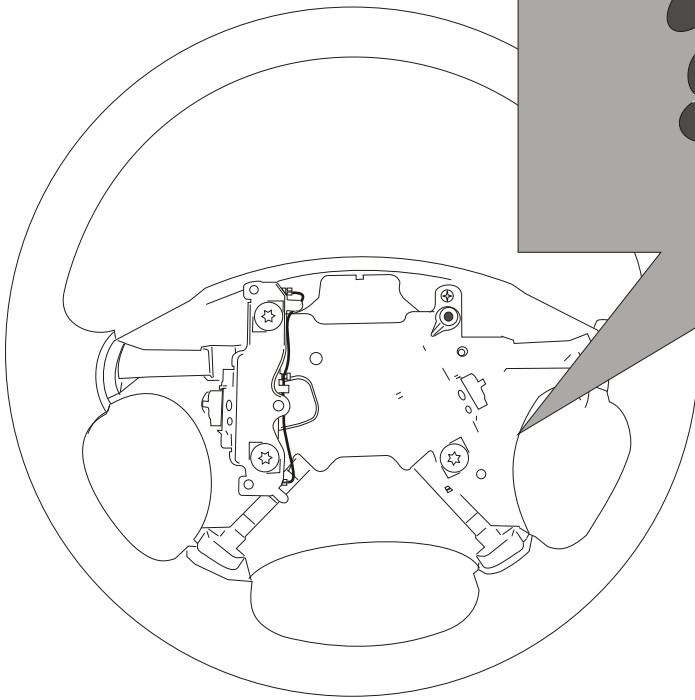

Fasten the unit on the edge.

Check that control wire have enough space between airbag and edge, when pressing the airbag/ horn.

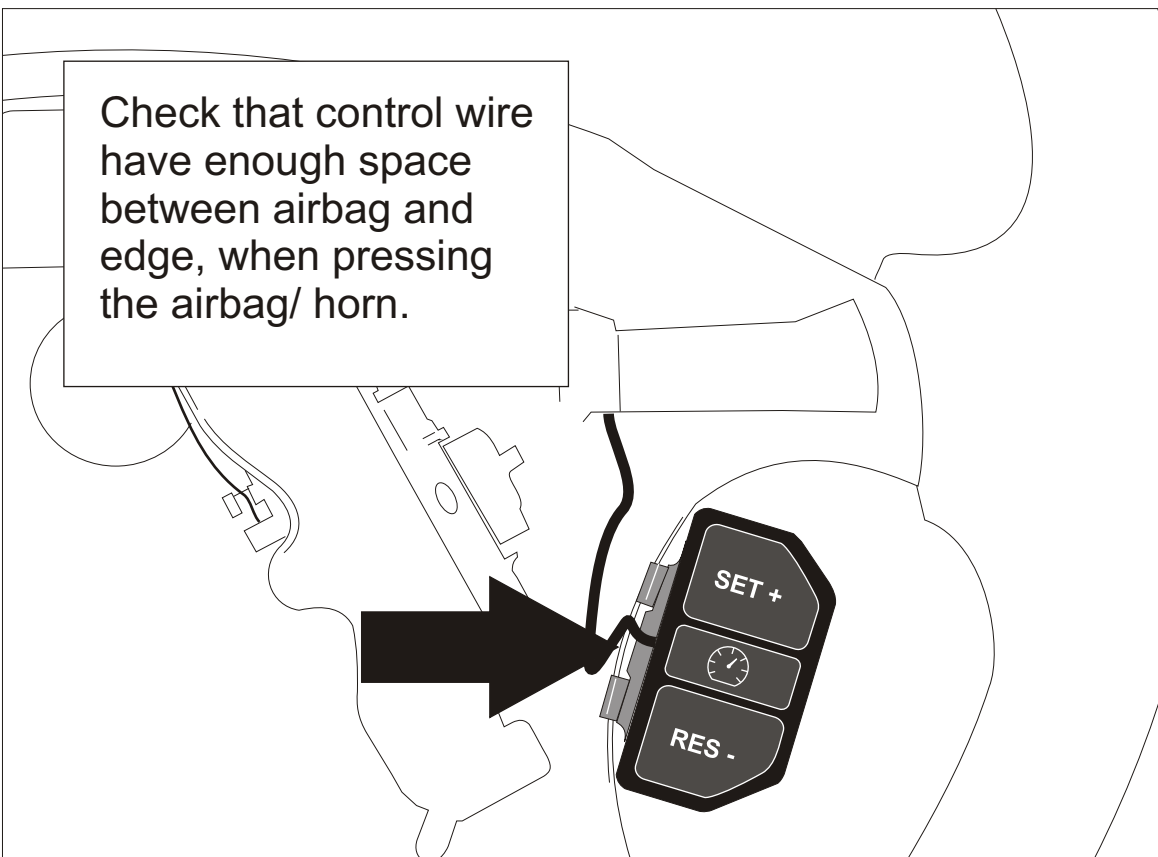

Interface the horn wire

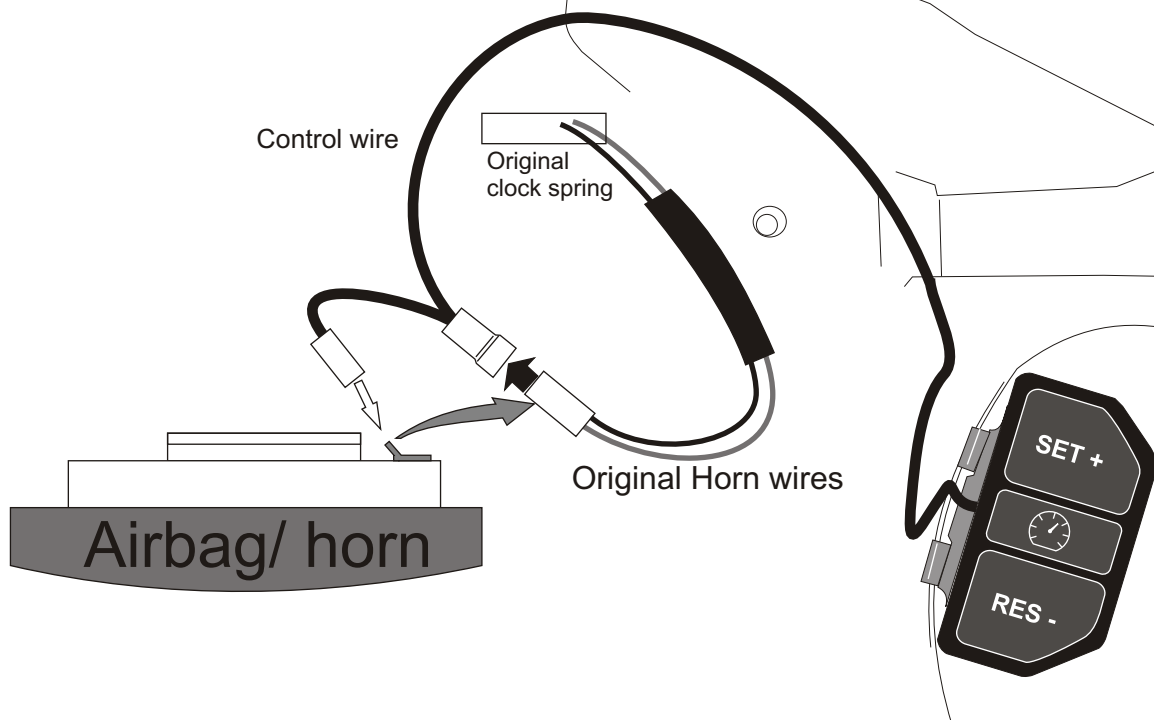

Remove

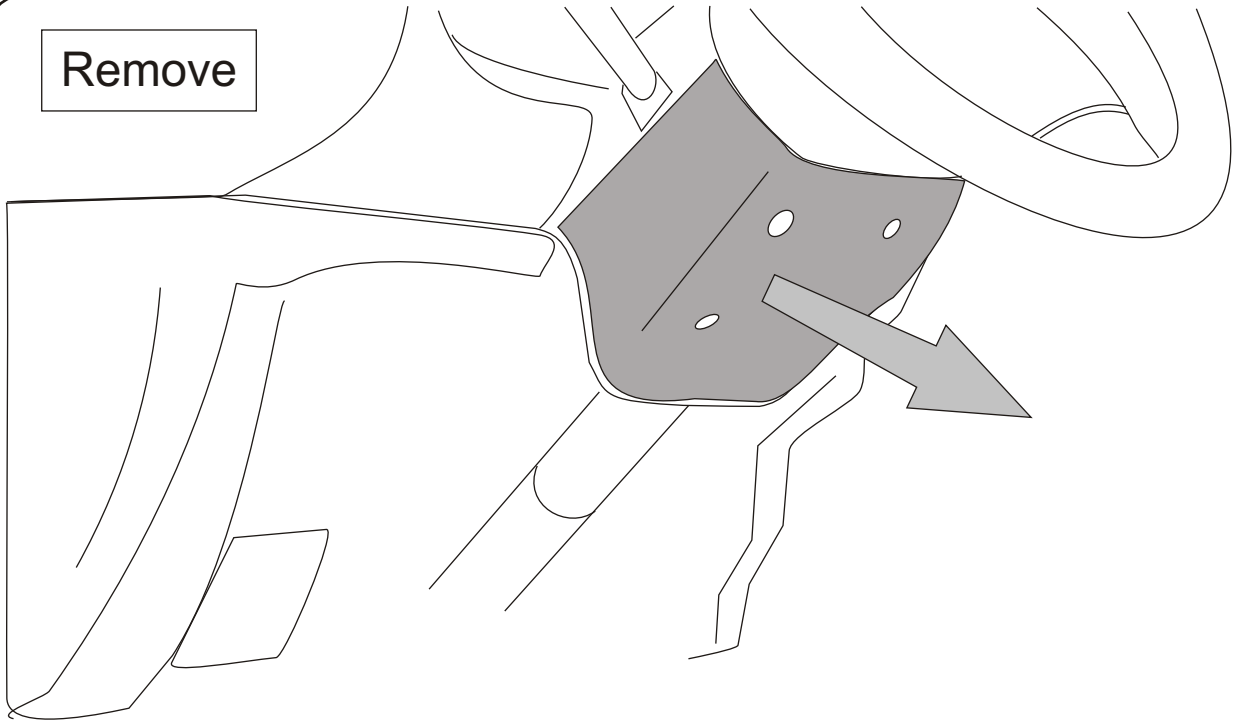

Locate the Black horn wire connector

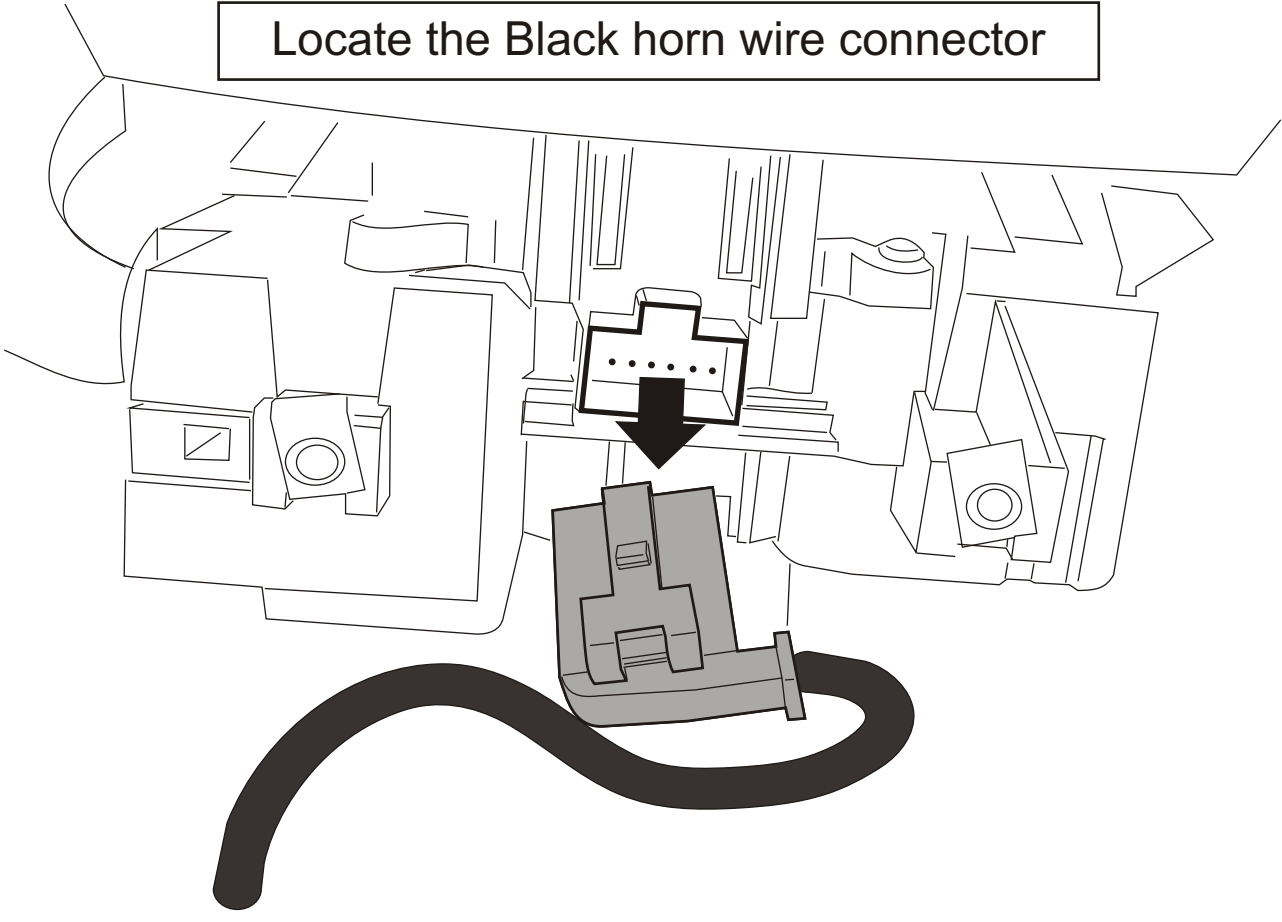

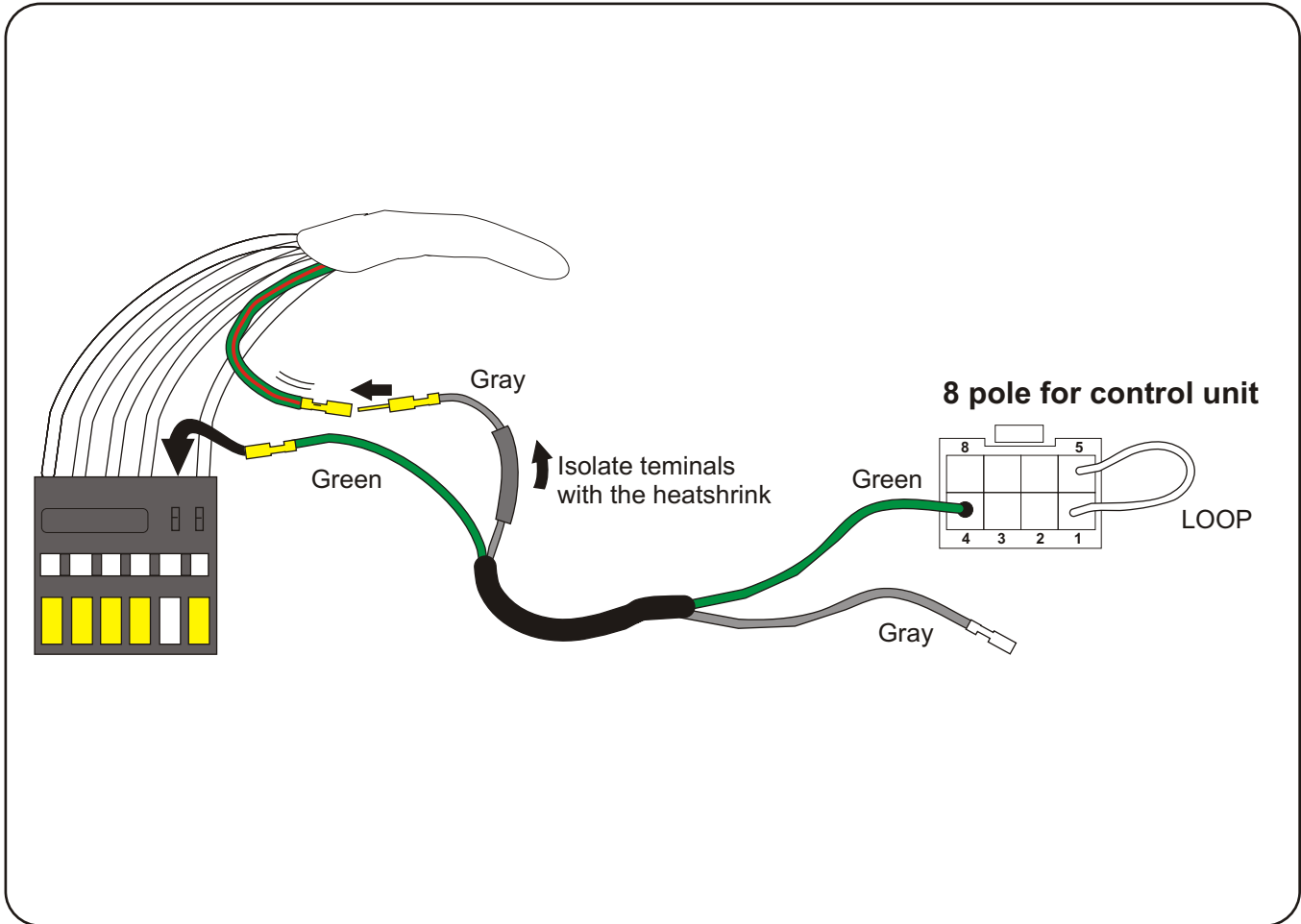
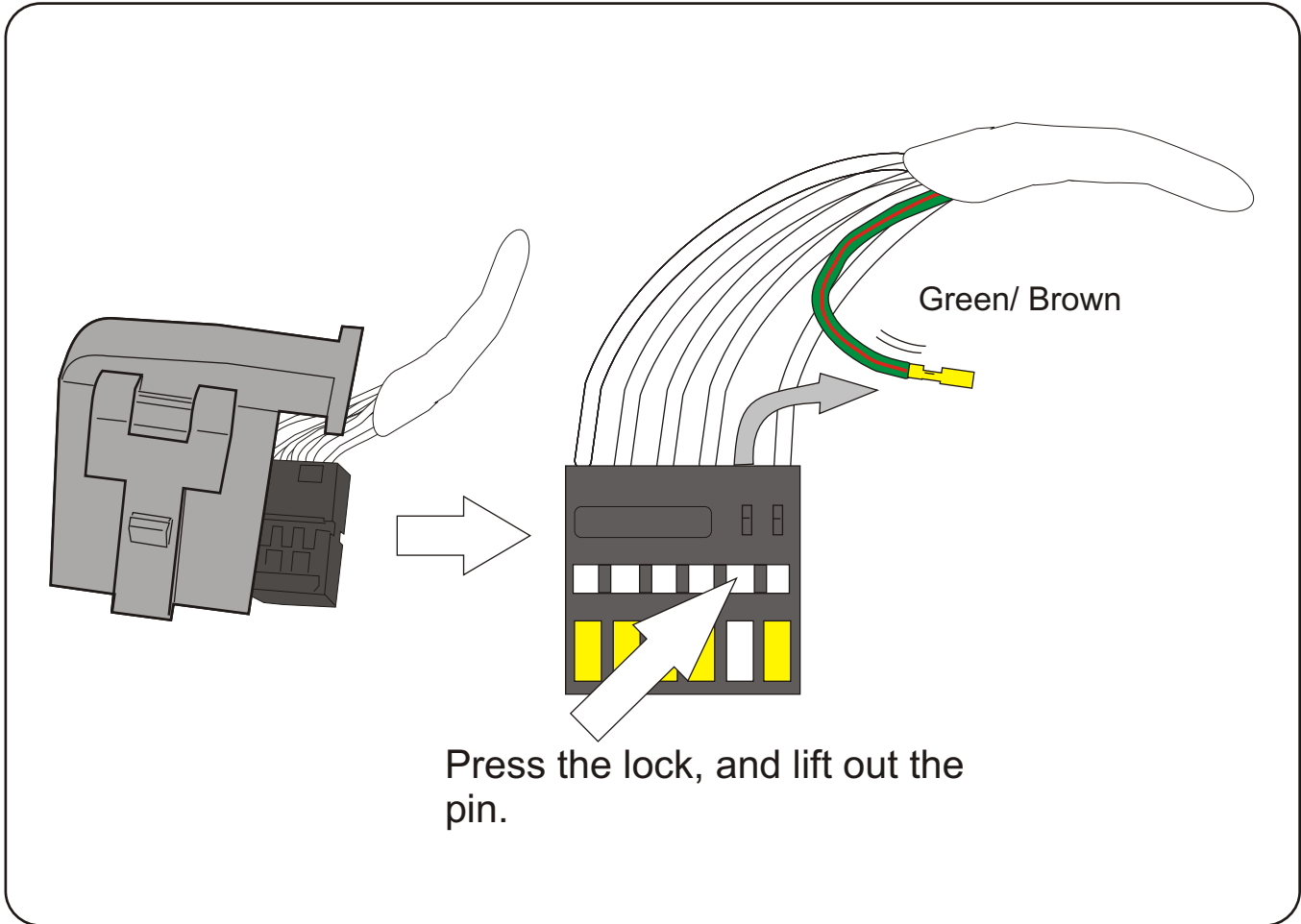

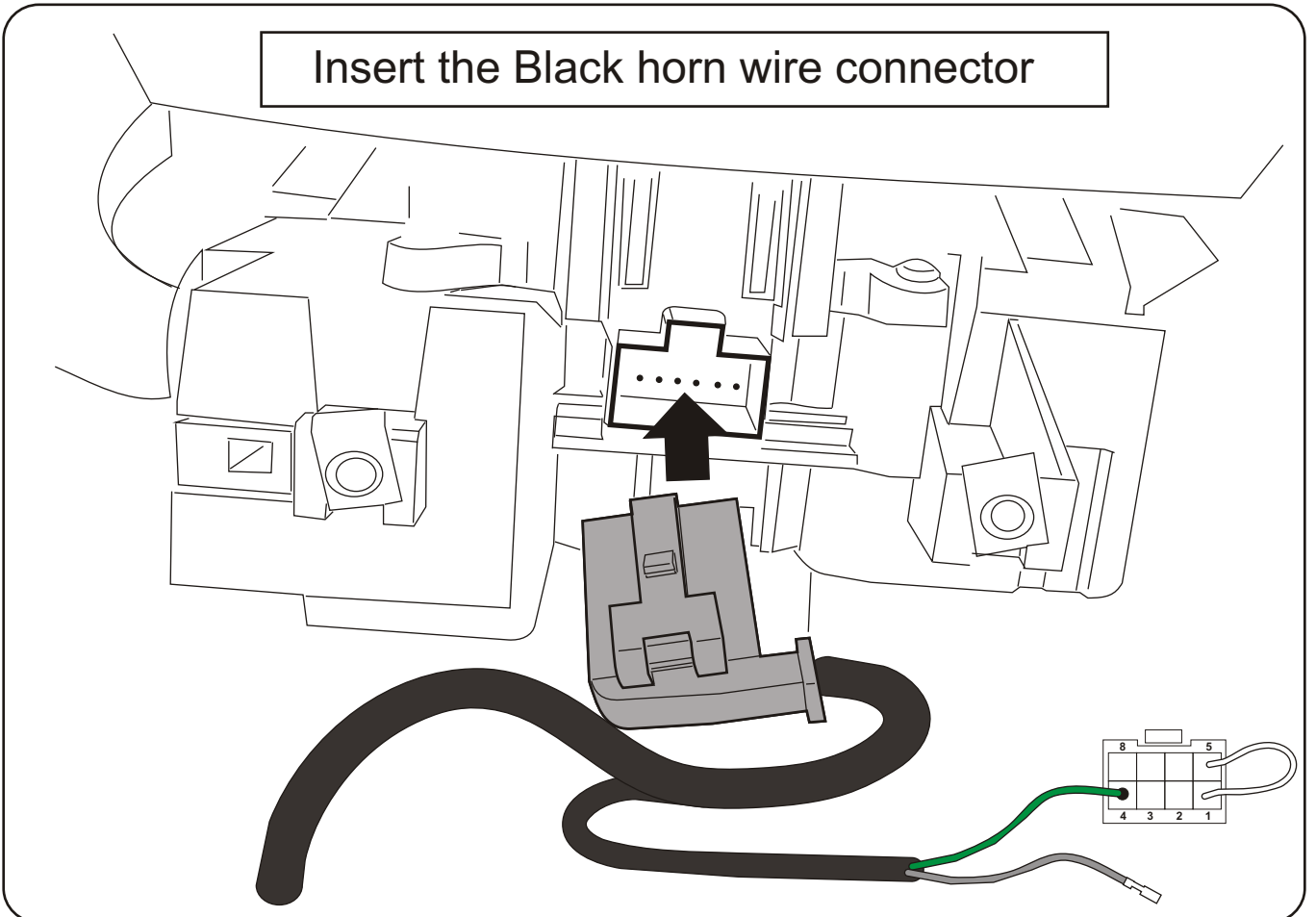
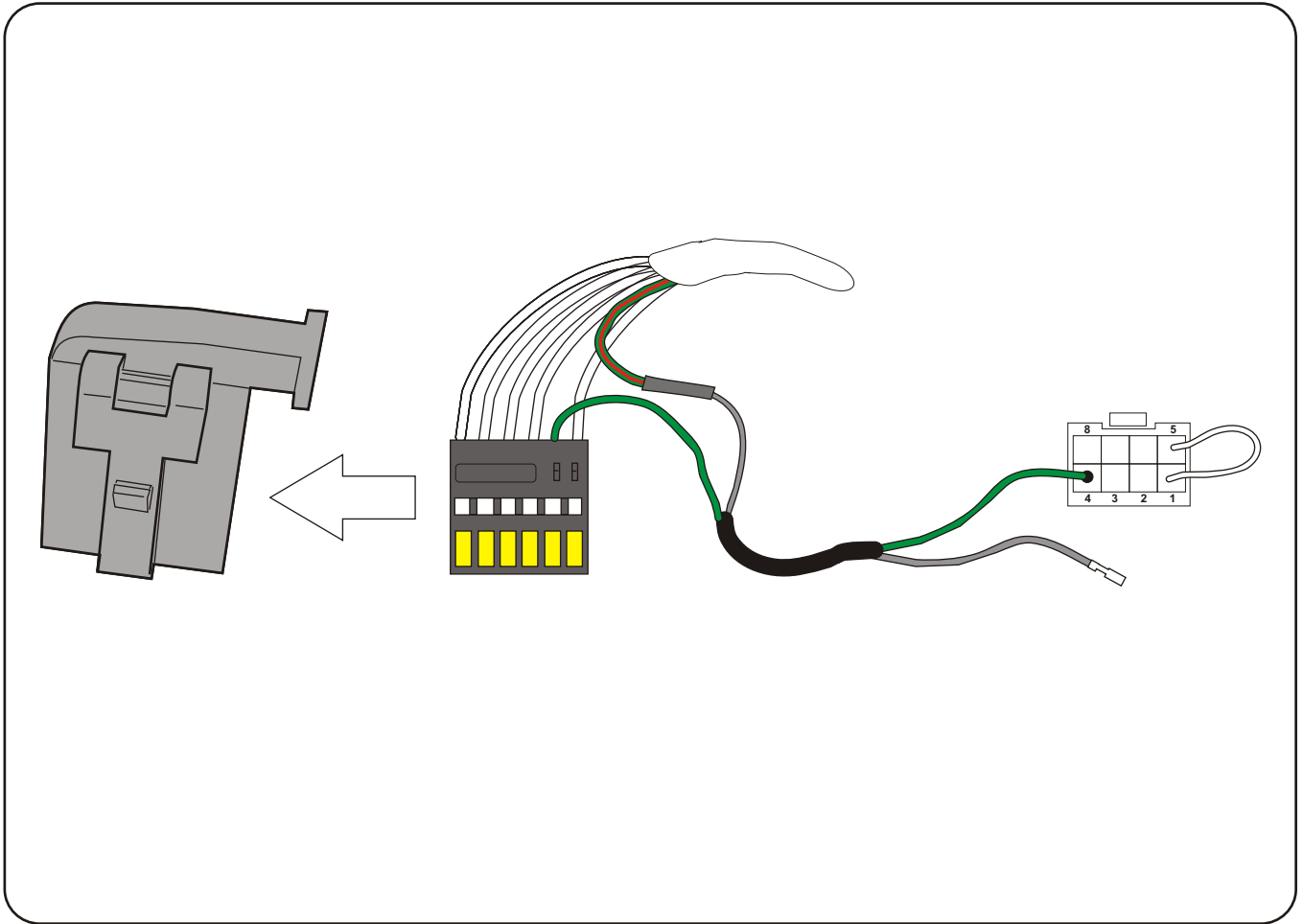

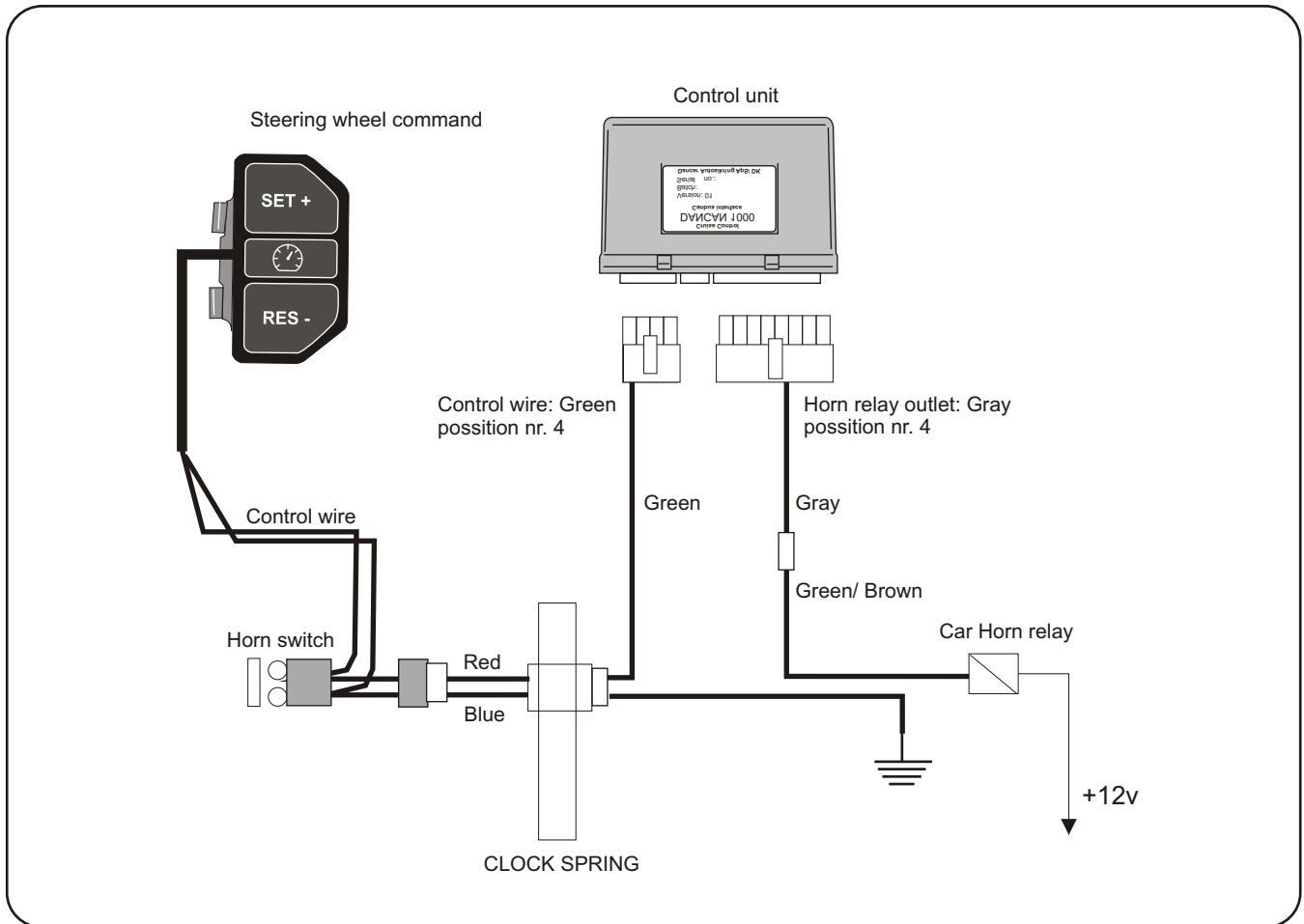
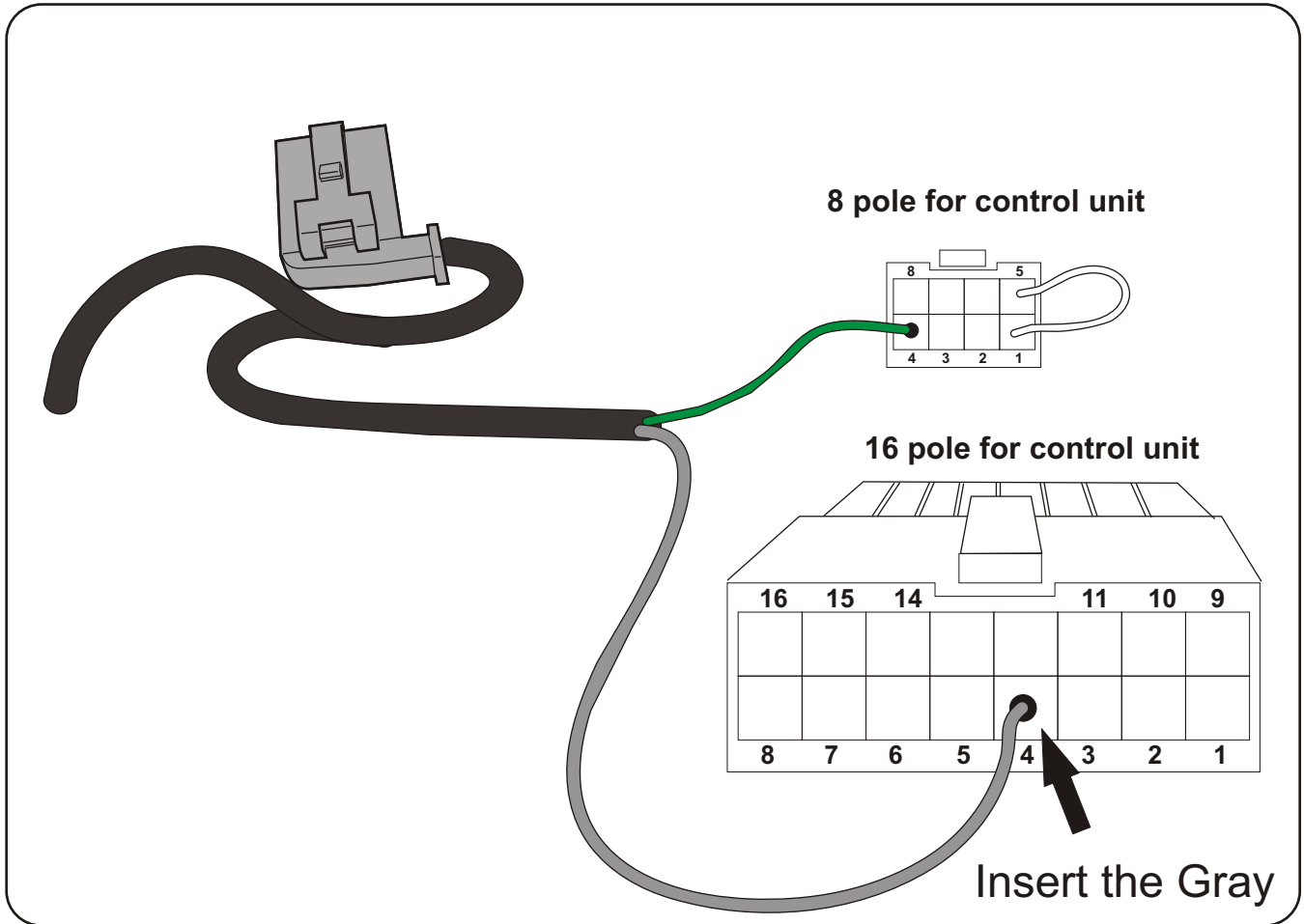

FINAL PROGRAMMING

1

Buttons used for programming

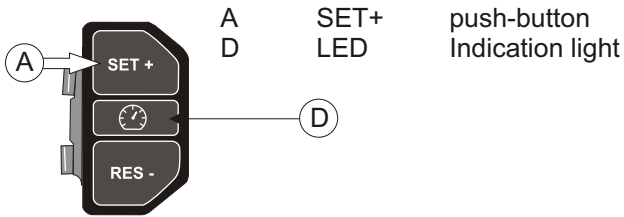

Steering wheel
remote control

2

Insert 8 pole connector

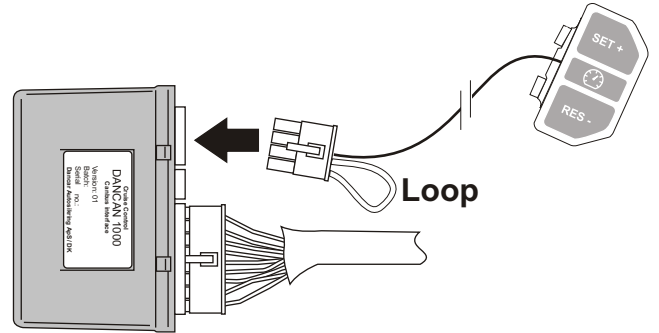

3

Access for programming

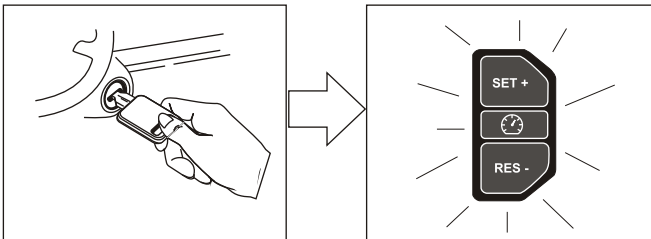

Turn ignition ON

Light up

4

Enter the correct program

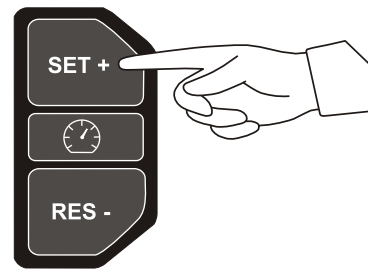

Press number of times, indicated
for current car. See the car program no.
to enter, on the list in main fitting
instruction.

5

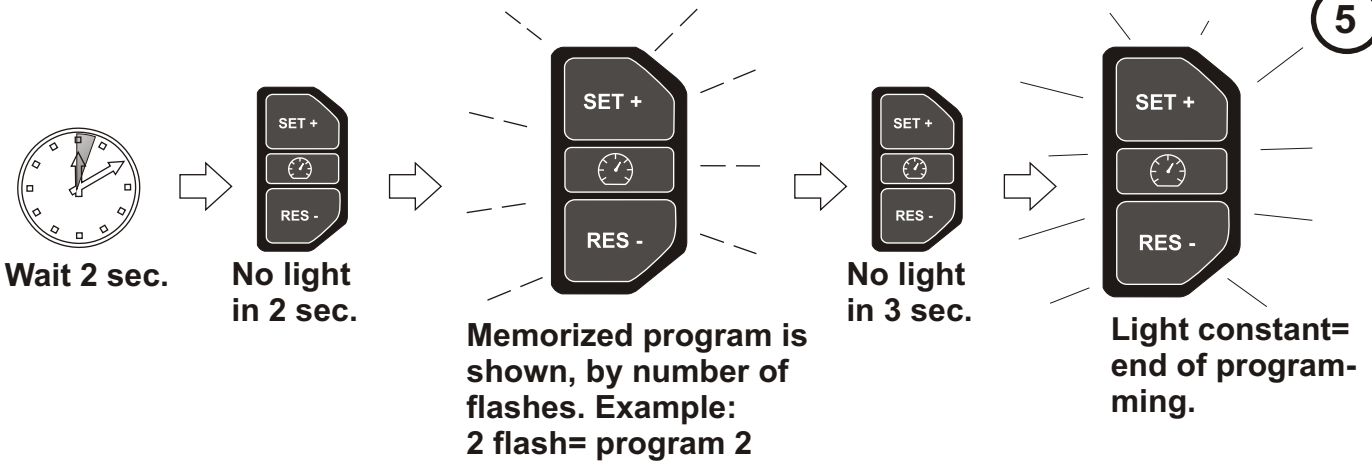

6

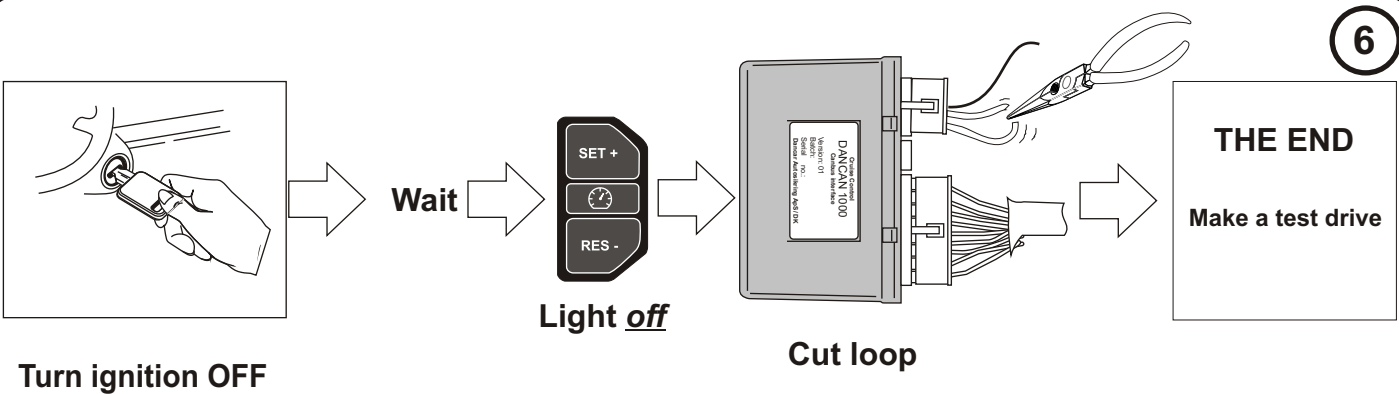

Turn ignition OFF

Light off

Cut loop

THE END

Make a test drive

Info

Dealer stamp

Day of installation: