

# Instruction



**Genuine  
Accessories**

**GB**

Model	Terracan H1 Matrix 1/9-2007 W/O ESP (instruction see page 8-10)	Description	Cruise control
Year	2006	Part number	E9600 99012A HYU BASIC 4
Type of model	CRDI	Manufacturer	Dancar Autosikring
Production	13/12/06	Installation time	60 min.



The system is tested and approved at speeds between 30 km/h and 140 km/h.

The product which is described in the guide was developed, produced and inspected as regards the necessary security precautions. In order to guarantee a faultless operation and thus exclude the danger to people and objects, this product must be mounted in accordance with professional guidelines. Internal fitting must thus only be performed by professionals who possess the necessary technical knowledge and the necessary tools. The mounting guide must be read thoroughly. Before starting the mounting you must make sure that the mounting kit is complete.

**CC 002**

## CONTENTS BASIC 4

**DC 20100**

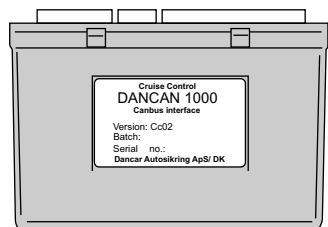

Software  
2.x

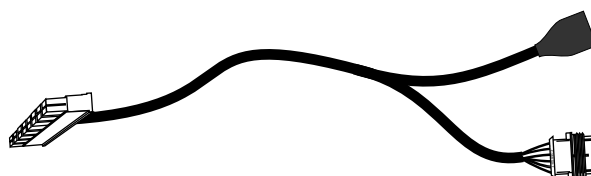

Main cable

**DC 10112  
TERRACAN**

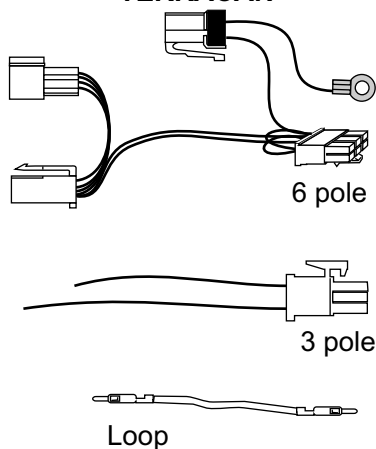

**DC 10110  
H1**

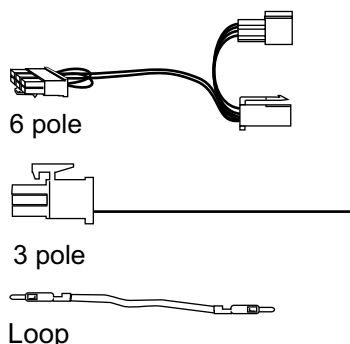

**JKH0014**



Fitting instruction

**Clutch switch  
Hyundai part no:  
93810-2E000**

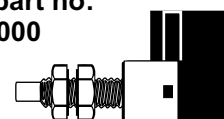



## TERRACAN and H1

1

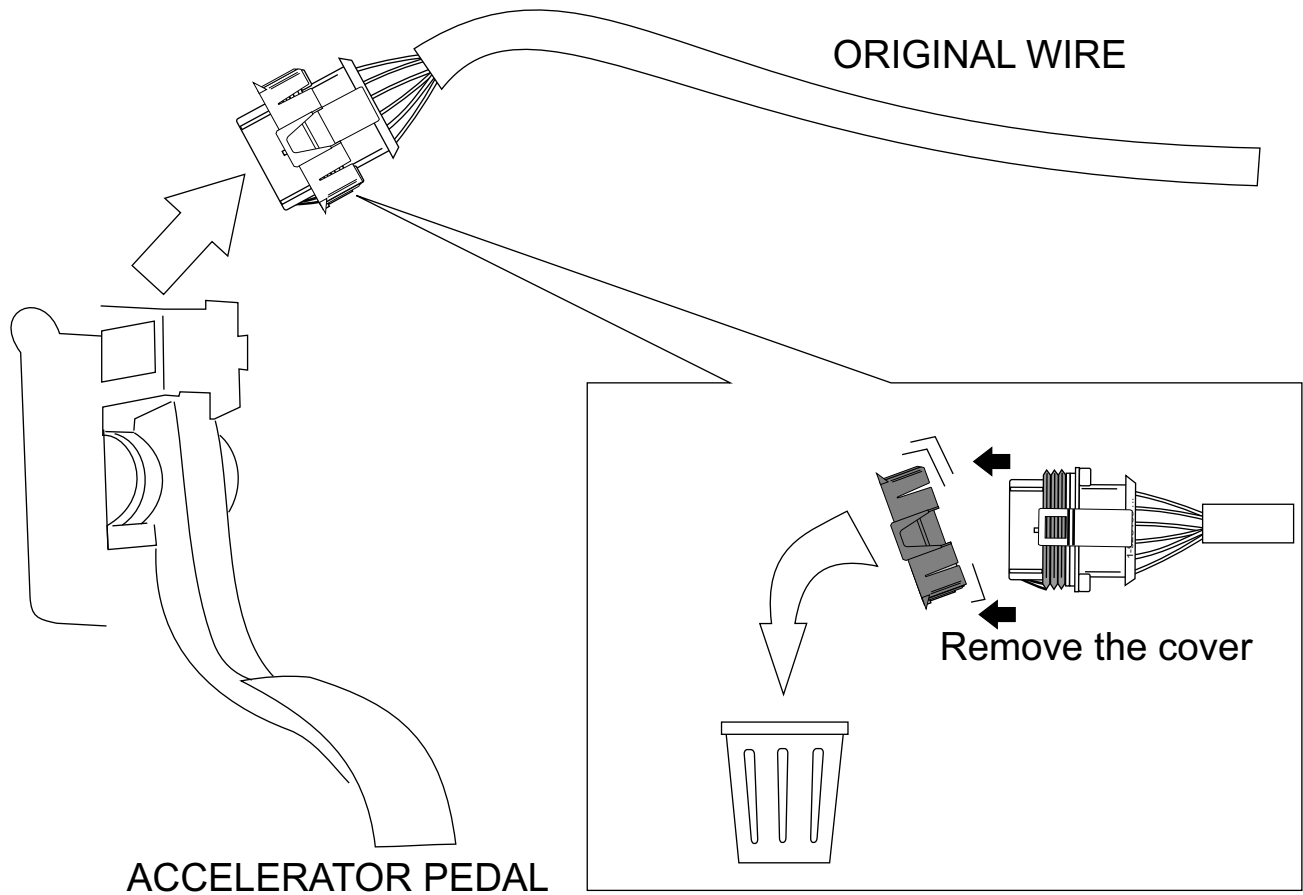

## TERRACAN and H1

2

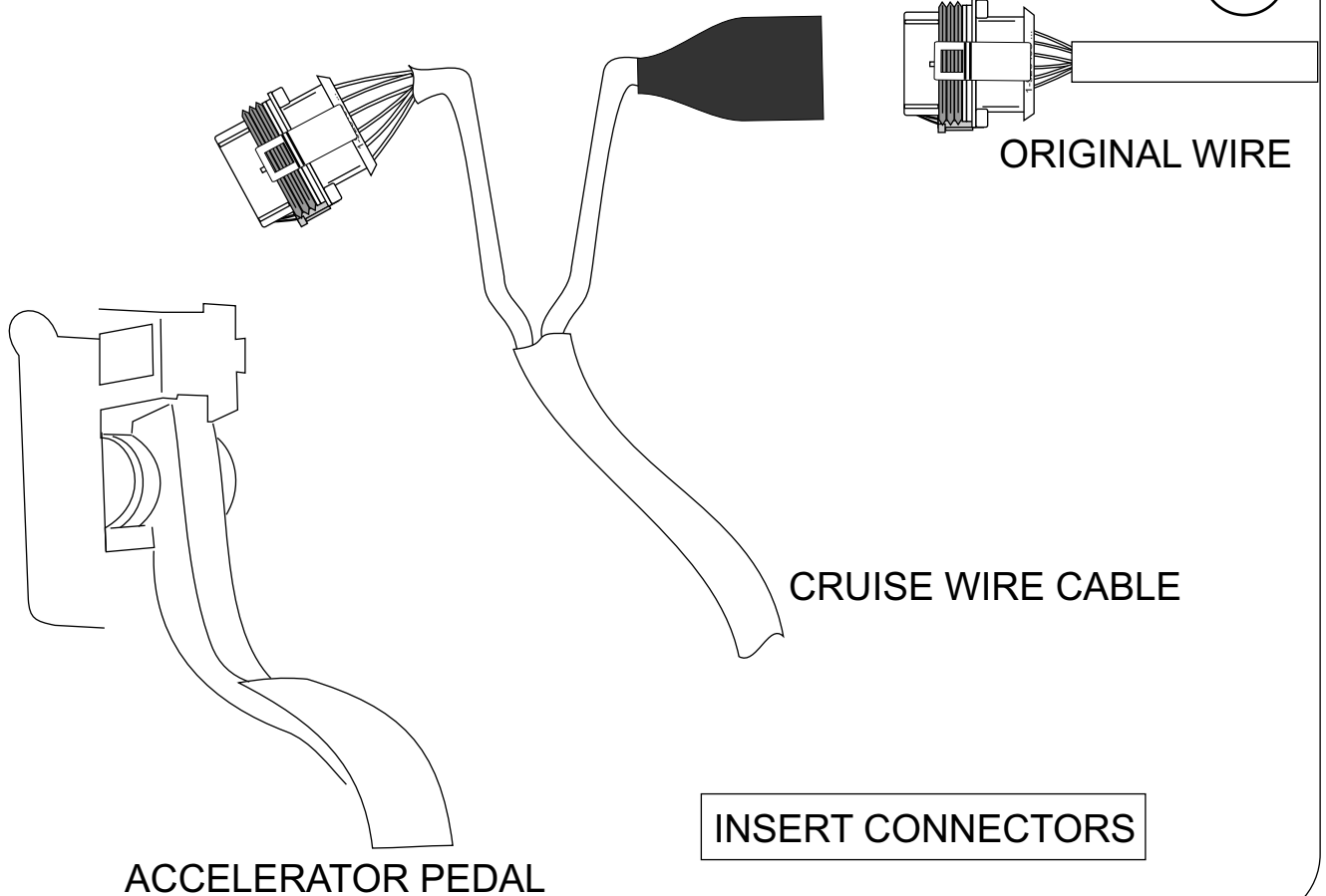



## TERRACAN

3

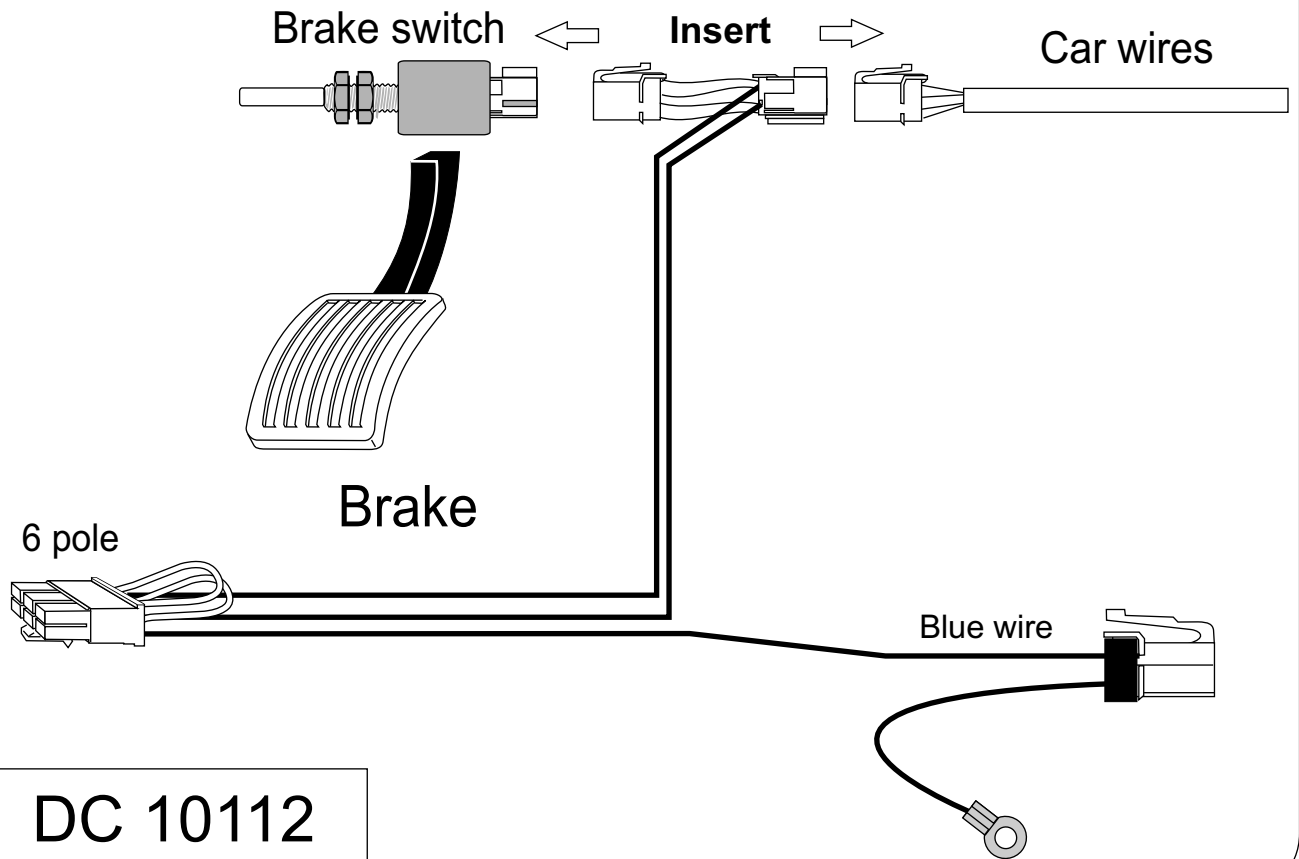

DC 10112

## TERRACAN

4

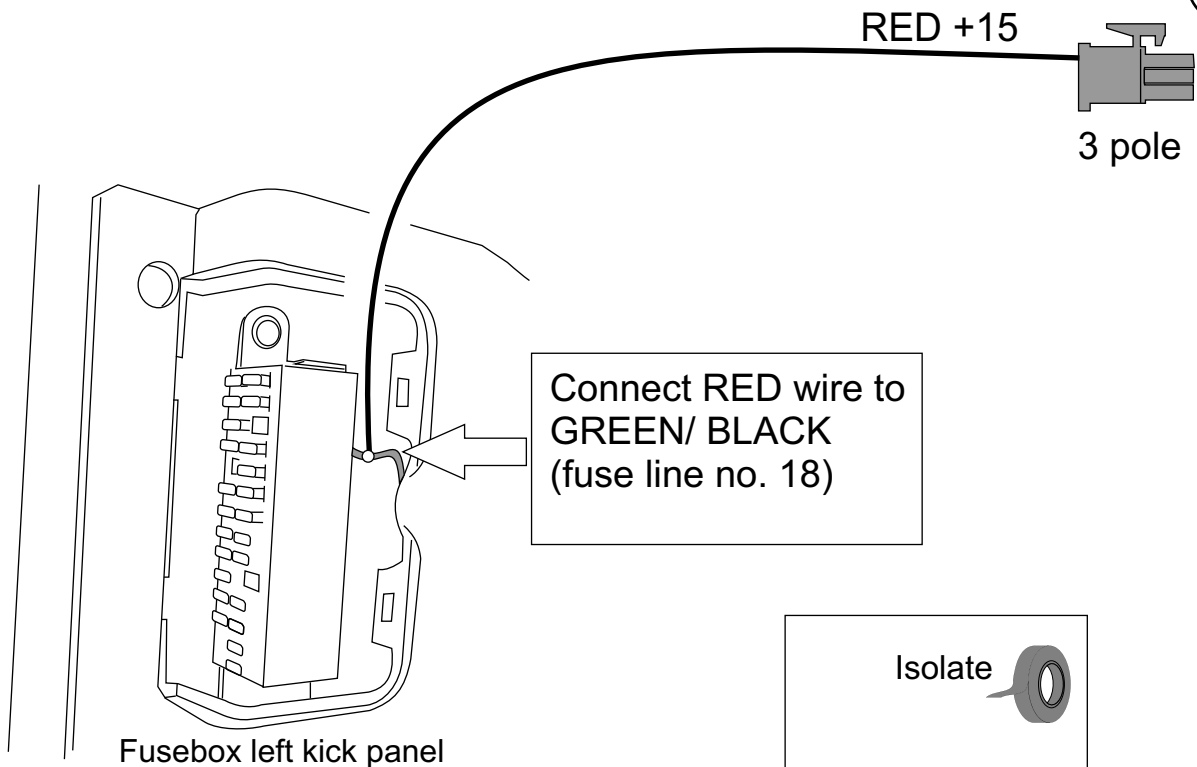

DC 10112

Isolate



Soldering



**TERRACAN**  
**WITH MANUAL GEARBOX**  
replace existing bolt with clutch switch

5



Clutch switch  
Hyundai part no:  
93810-38000

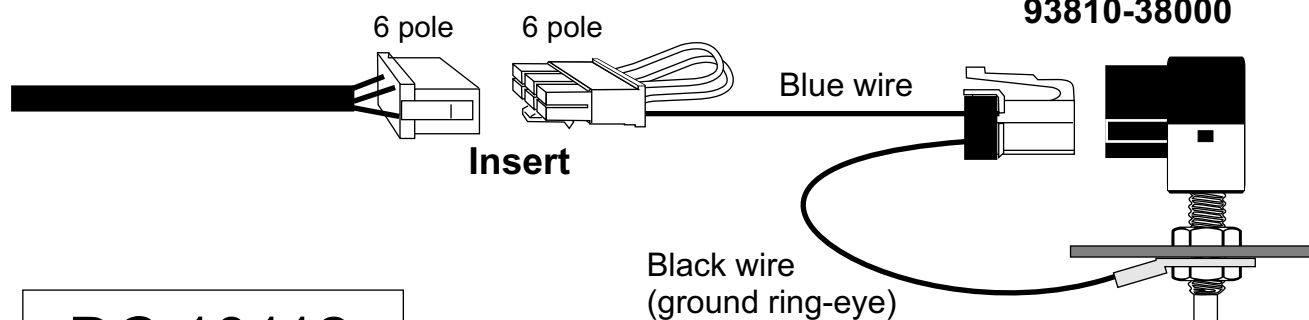

DC 10112

**TERRACAN**  
**WITH AUTOMATIC GEARBOX**

6

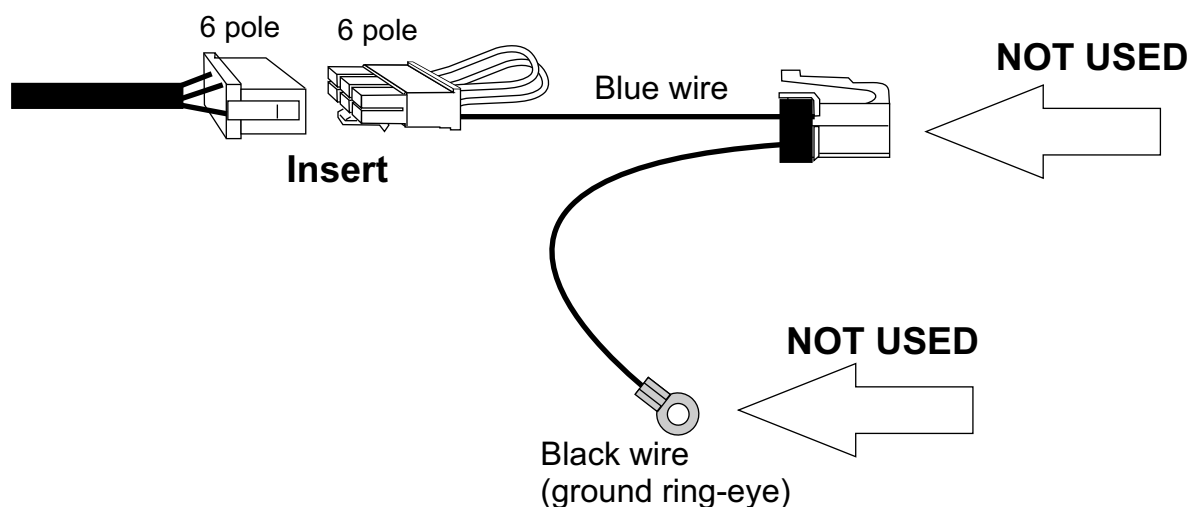

DC 10112



## TERRACAN

7

WHITE (speed signal)

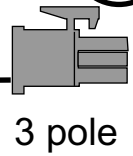

3 pole

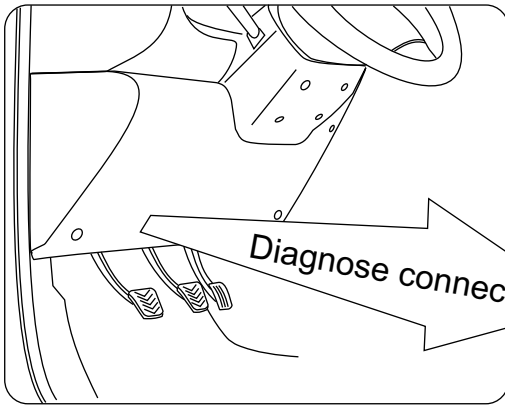

Diagnose connector

Isolate



Soldering

Connect WHITE wire to  
YELLOW/ ORANGE  
(poss. no. 14)

## TERRACAN

8

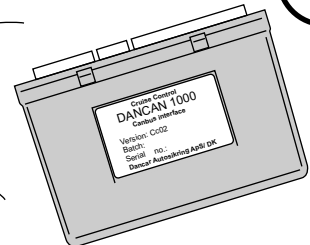

Control box

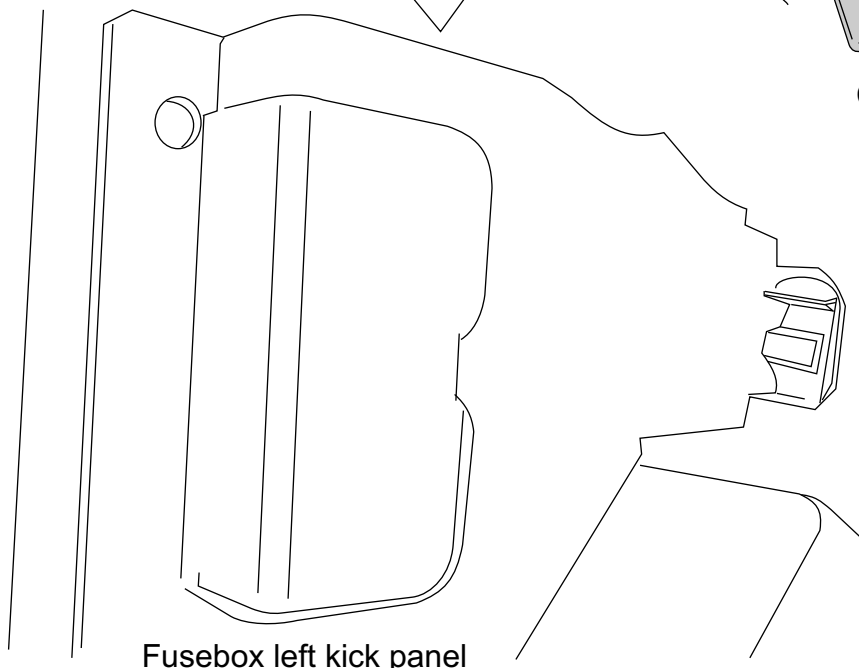

Fusebox left kick panel



H1

9

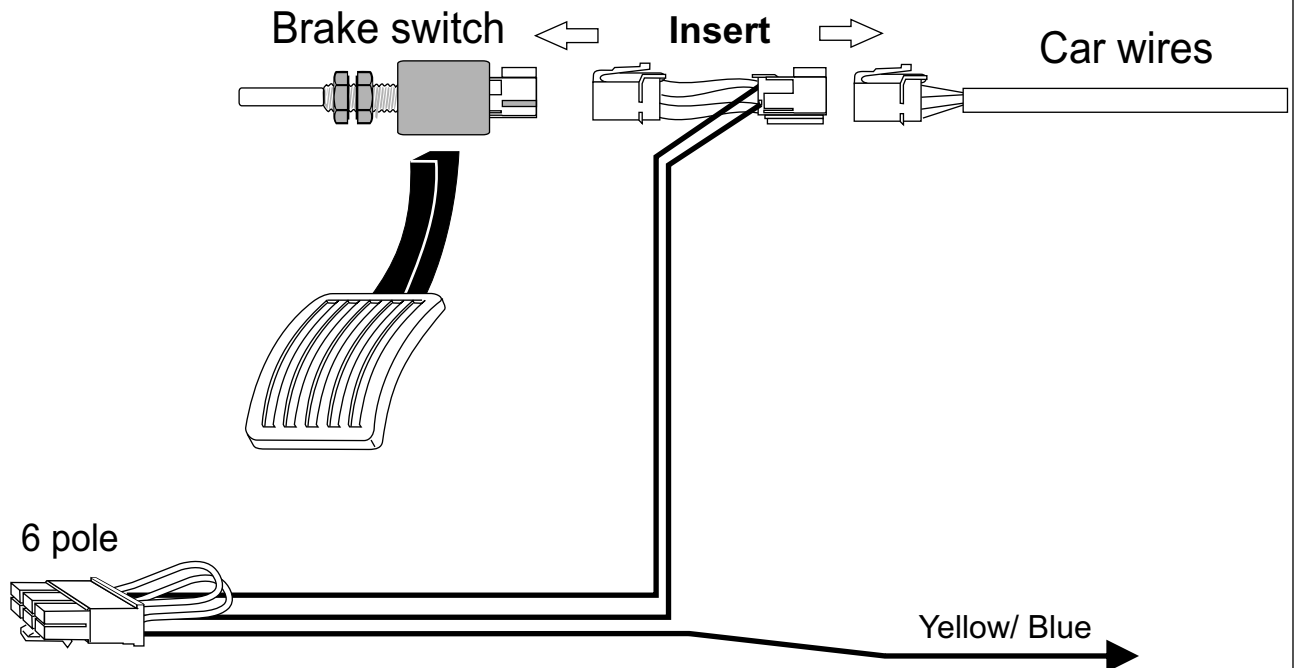

DC 10110

H1

10

WITH MANUAL GEARBOX

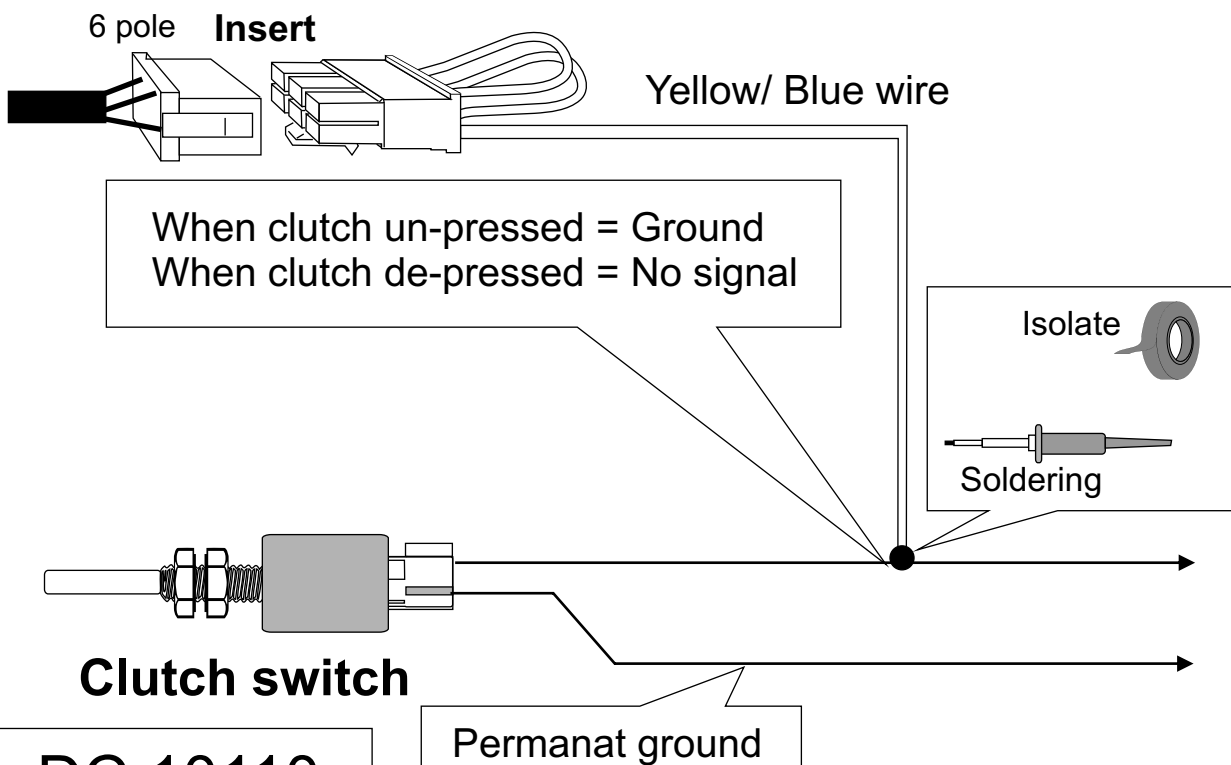

DC 10110



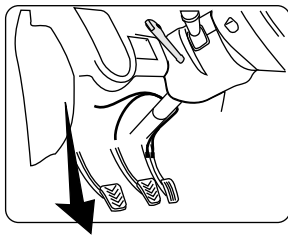

H1

DC 10110

White

3 Pole

Isolate

Soldering

ETACM

No. 24  
(Blue/ Orange)

## GENERAL SCHEME

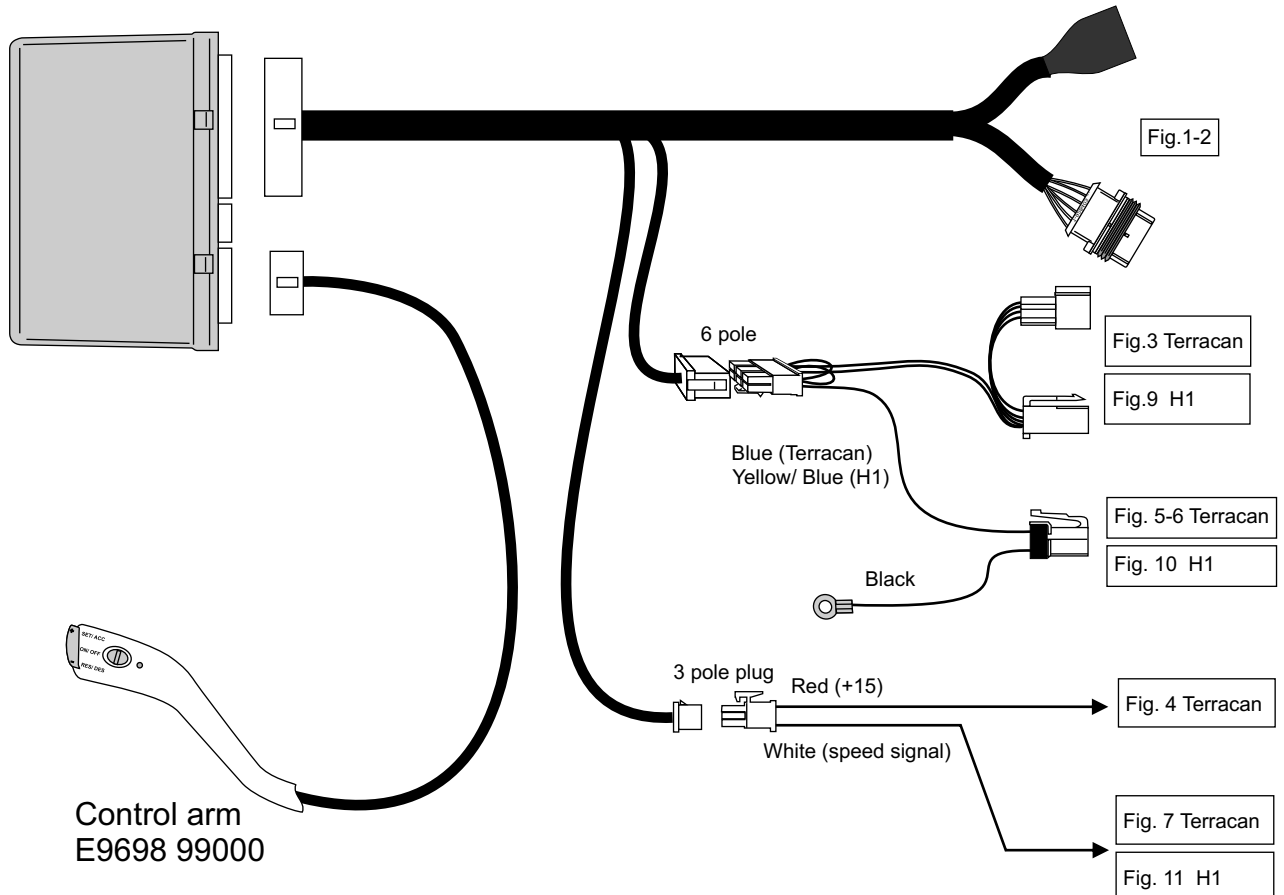



## CAR-PROGRAM LIST

USABLE CONTROL UNIT



CAR-PROGRAM LIST					USABLE CONTROL UNIT	
Car model	Year	Remark	Program no:	E9698-99000		
Terracan HP	13/1 2006-		5	yes		
H1	13/1 2006-		1	yes		



Instruction	 <b>Genuine Accessories</b> 		
Model	*Matrix 1/9-2007-	Description	Cruise control
		Part number	
Type of model	CRDI	Manufacturer	Dancar Autosikring
Production	13/12/06	Installation time	40 min.
<p style="text-align: center;"> <b>Upgrade information to part no. E9600 99012A</b> </p> <p style="text-align: center;"> <b>* only for cars with-out ESP</b> </p>			

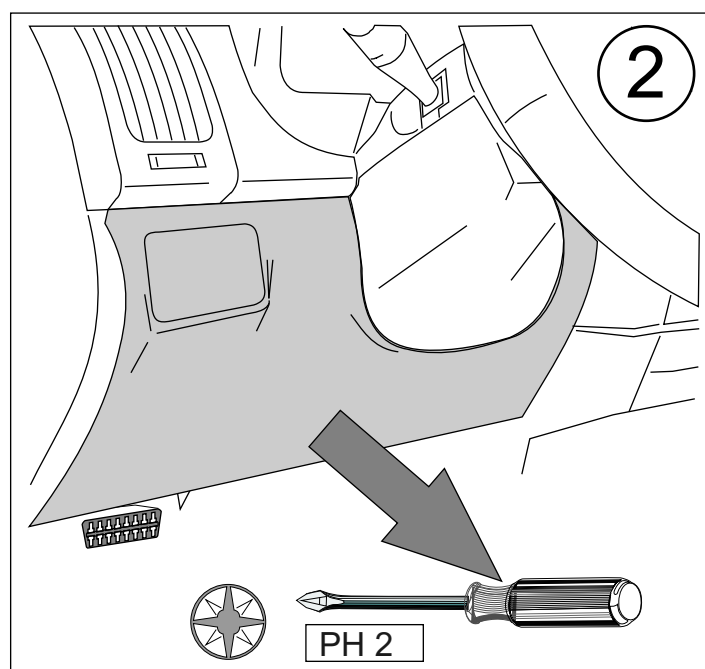
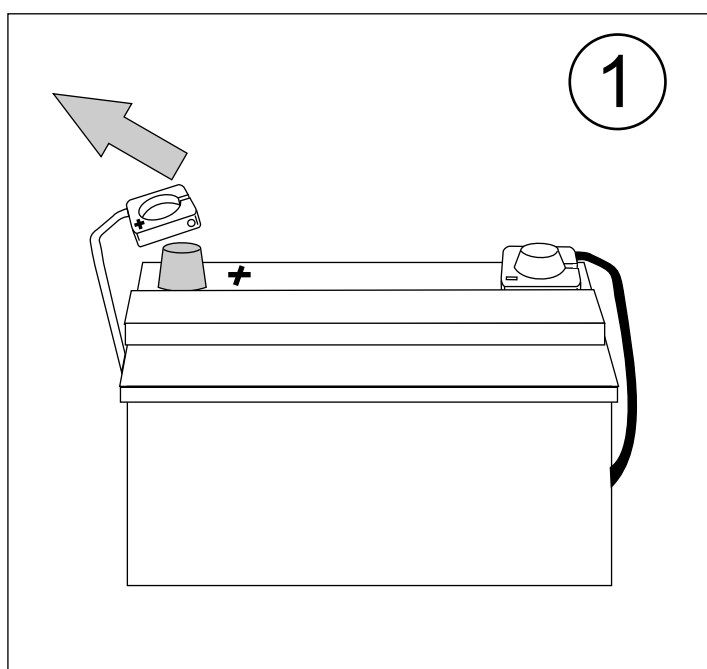



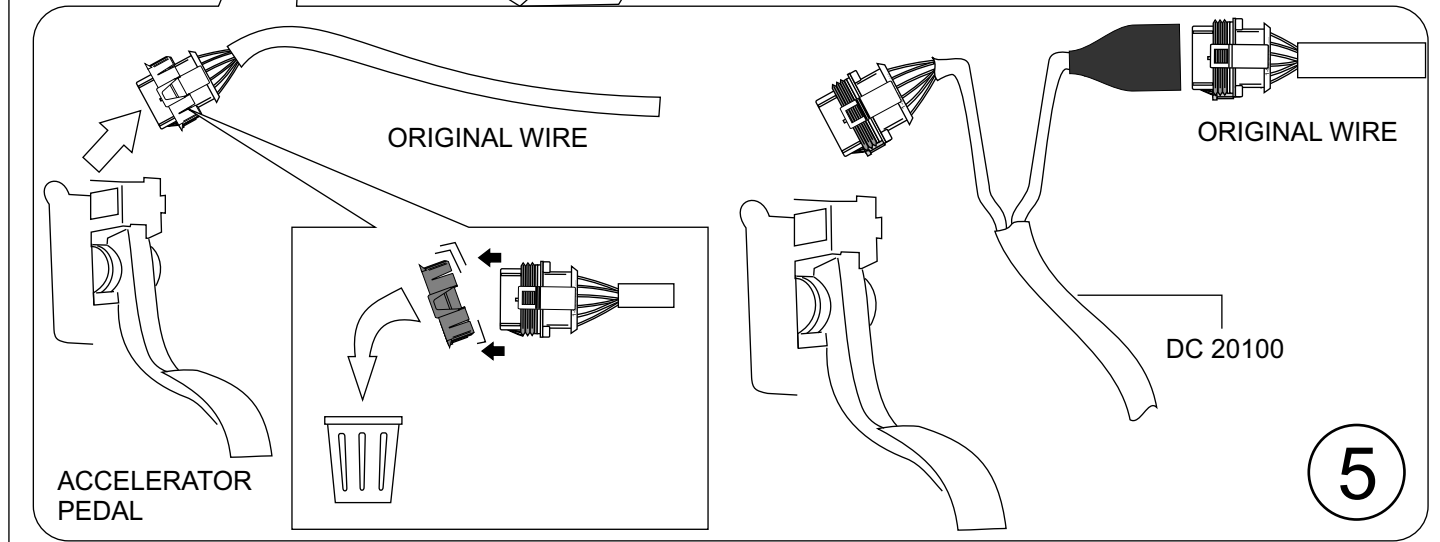
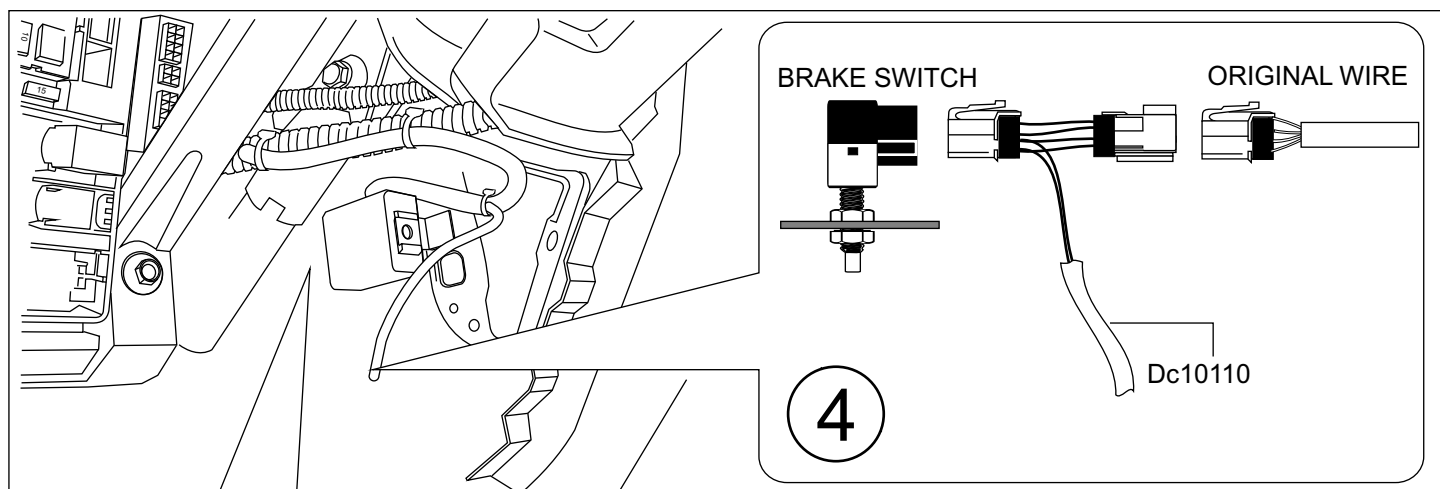
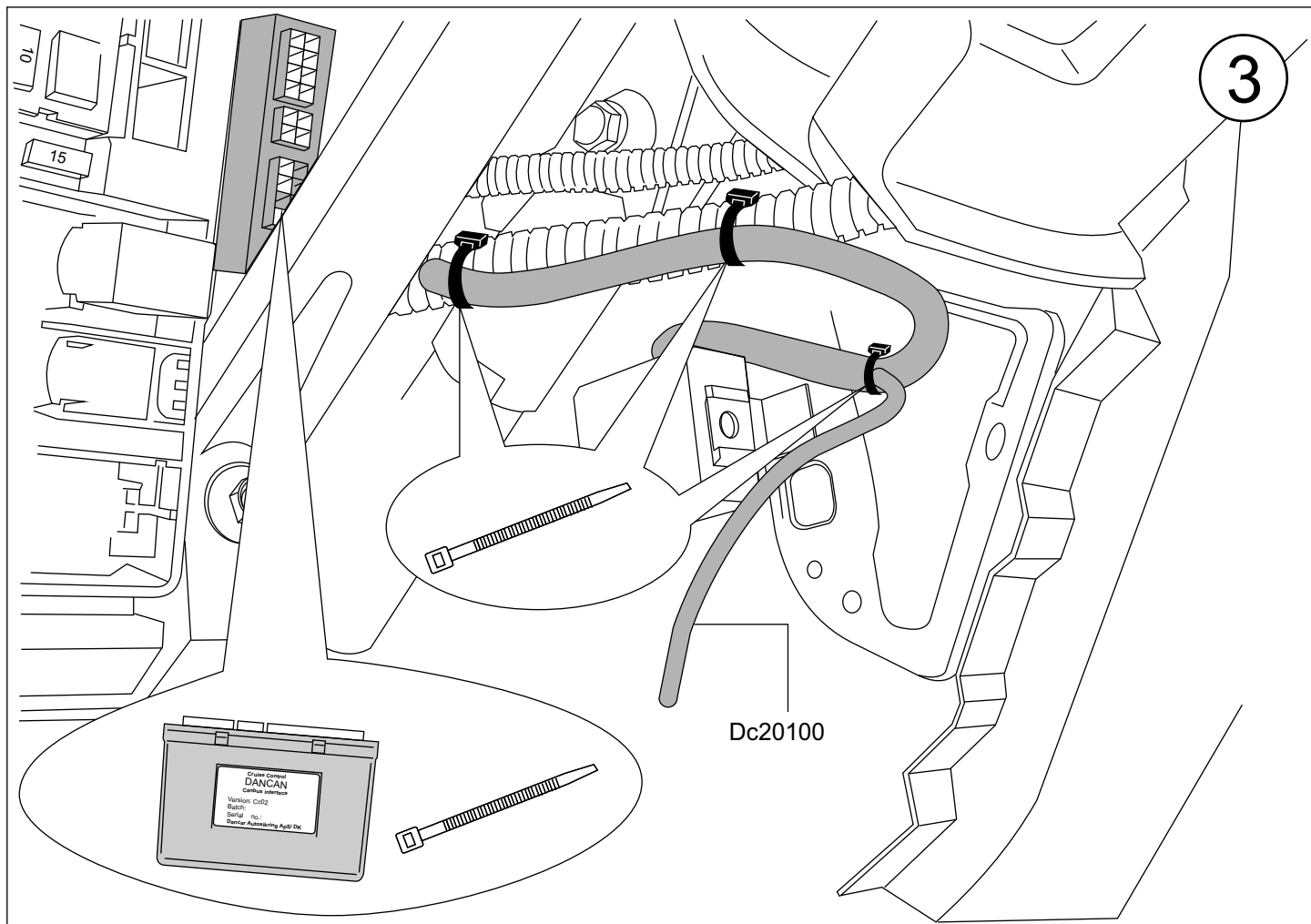



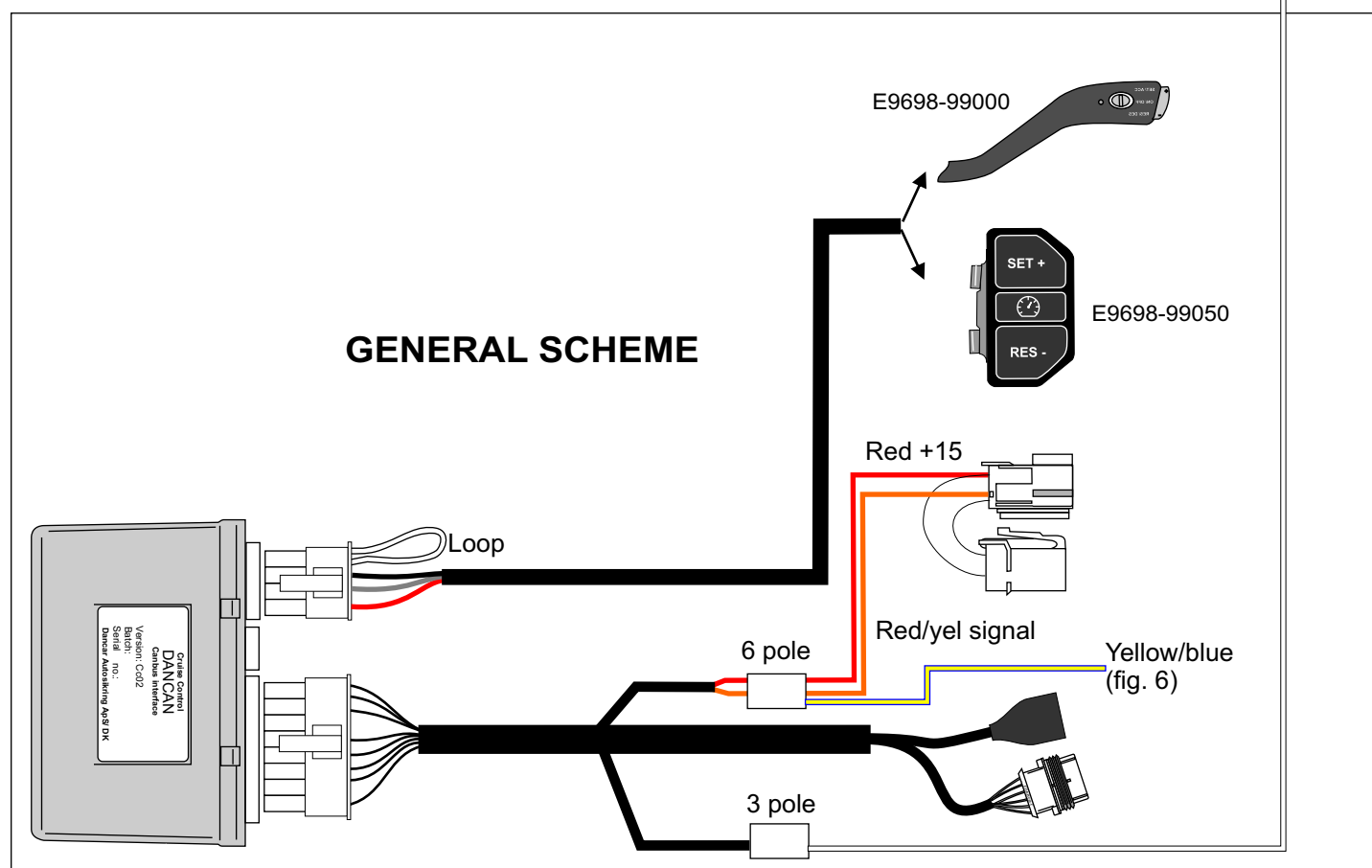
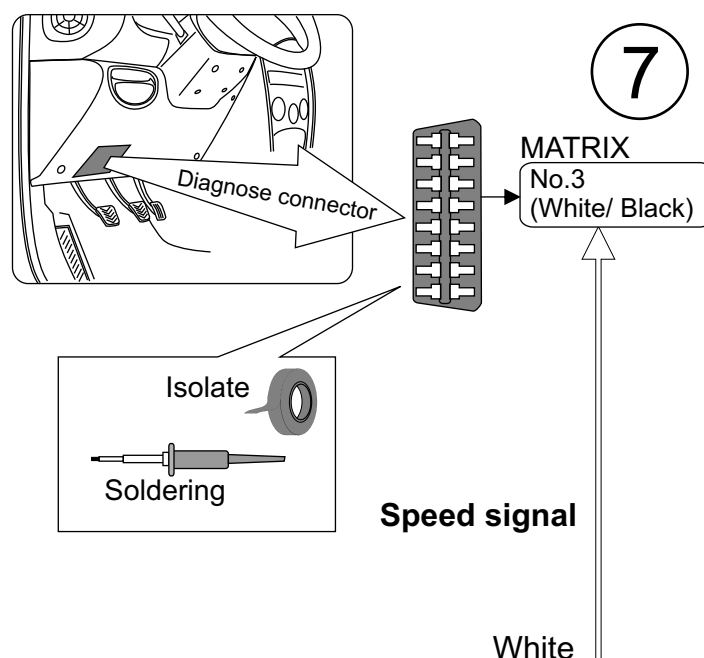
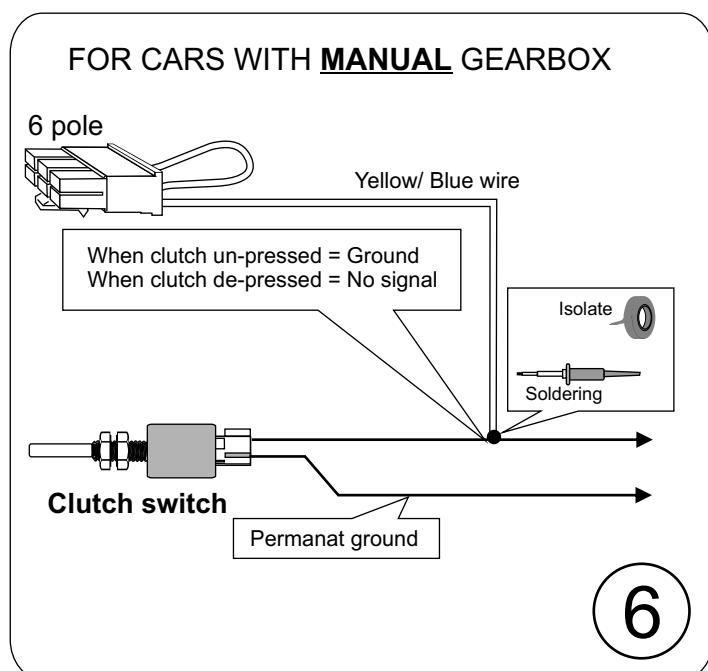

## CAR-PROGRAM LIST

Car model	Year	Remark	Program no:	E9698-99050	E9698-99000
Matrix	1/9-2007-	W/O ESP 5 MT 1.6	1	yes	yes

Updated fitting instruction and carlist see:  
**[www.dancar.dk](http://www.dancar.dk)**