

Instruction



GB

Model	CARENS 2006 → MAGENTIS 2005 → →	Type of model	CRDI
		Description	Cruise control
		Part number	E9600 66051A KIA CAN 2
		Manufacturer	Dancar Autosikring
Production	250507	Installation time	20 min.



TESTED AND
APPROVED
UNTIL 140 Km/h

The product which is described in the guide was developed, produced and inspected as regards the necessary security precautions. In order to guarantee a faultless operation and thus exclude the danger to people and objects, this product must be mounted in accordance with professional guidelines. Internal fitting must thus only be performed by professionals who possess the necessary technical knowledge and the necessary tools. The mounting guide must be read thoroughly. Before starting the mounting you must make sure that the mounting kit is complete.

CC 002

CONTENTS KIA CAN 2

DC 10600

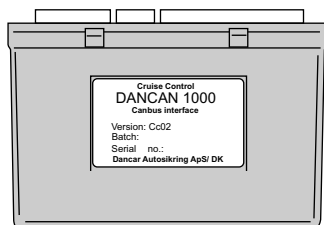

Version
5.x

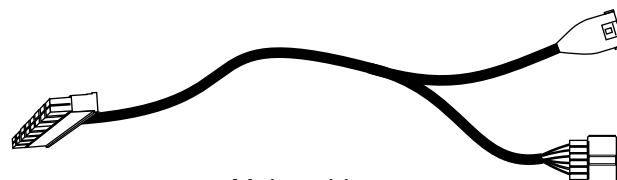

Main cable

DC 10310

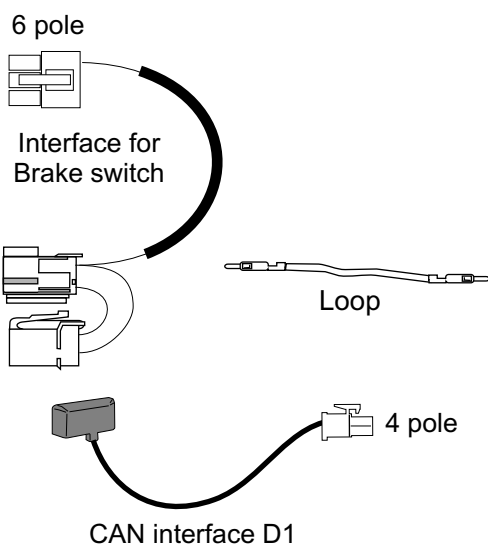

JKH0016GB

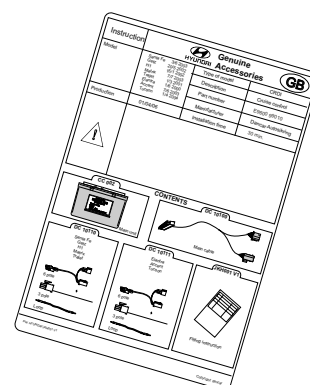

Instruction

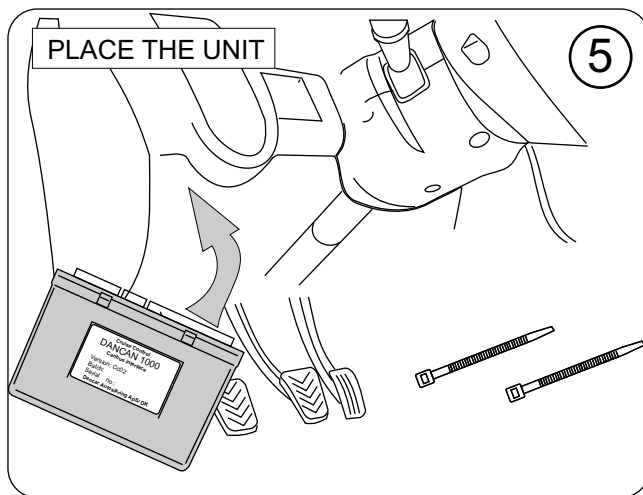
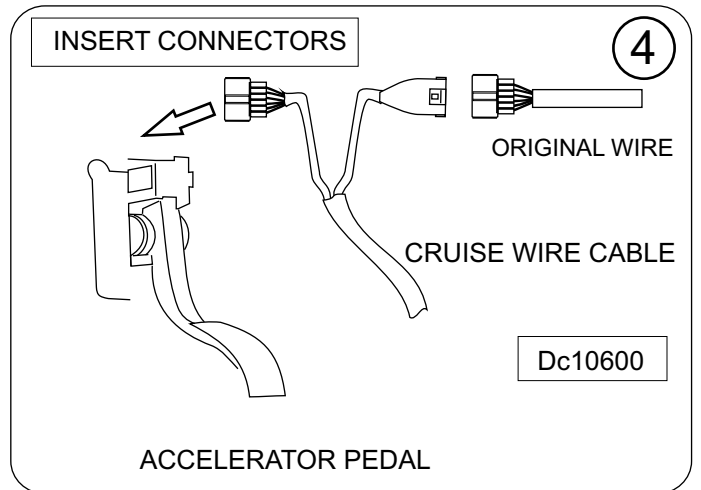
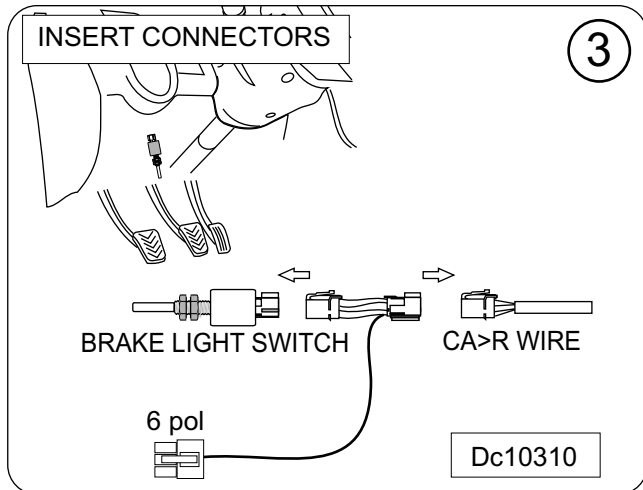
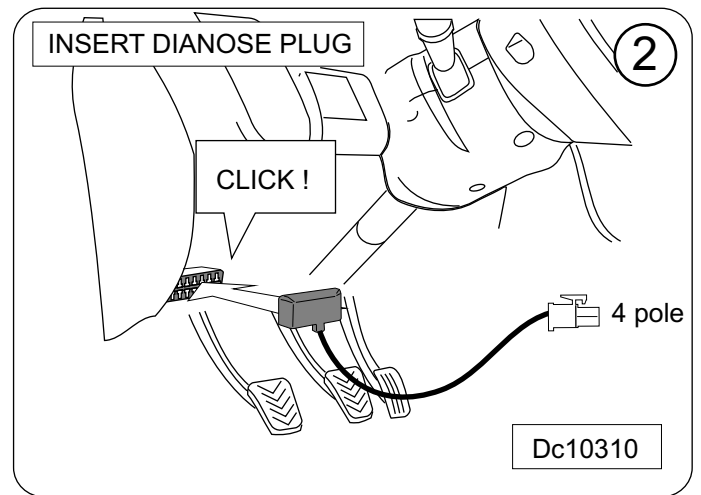
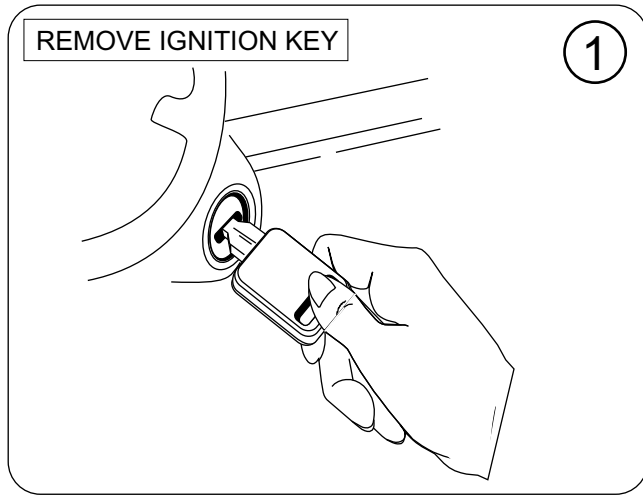

GENERAL SCHEME

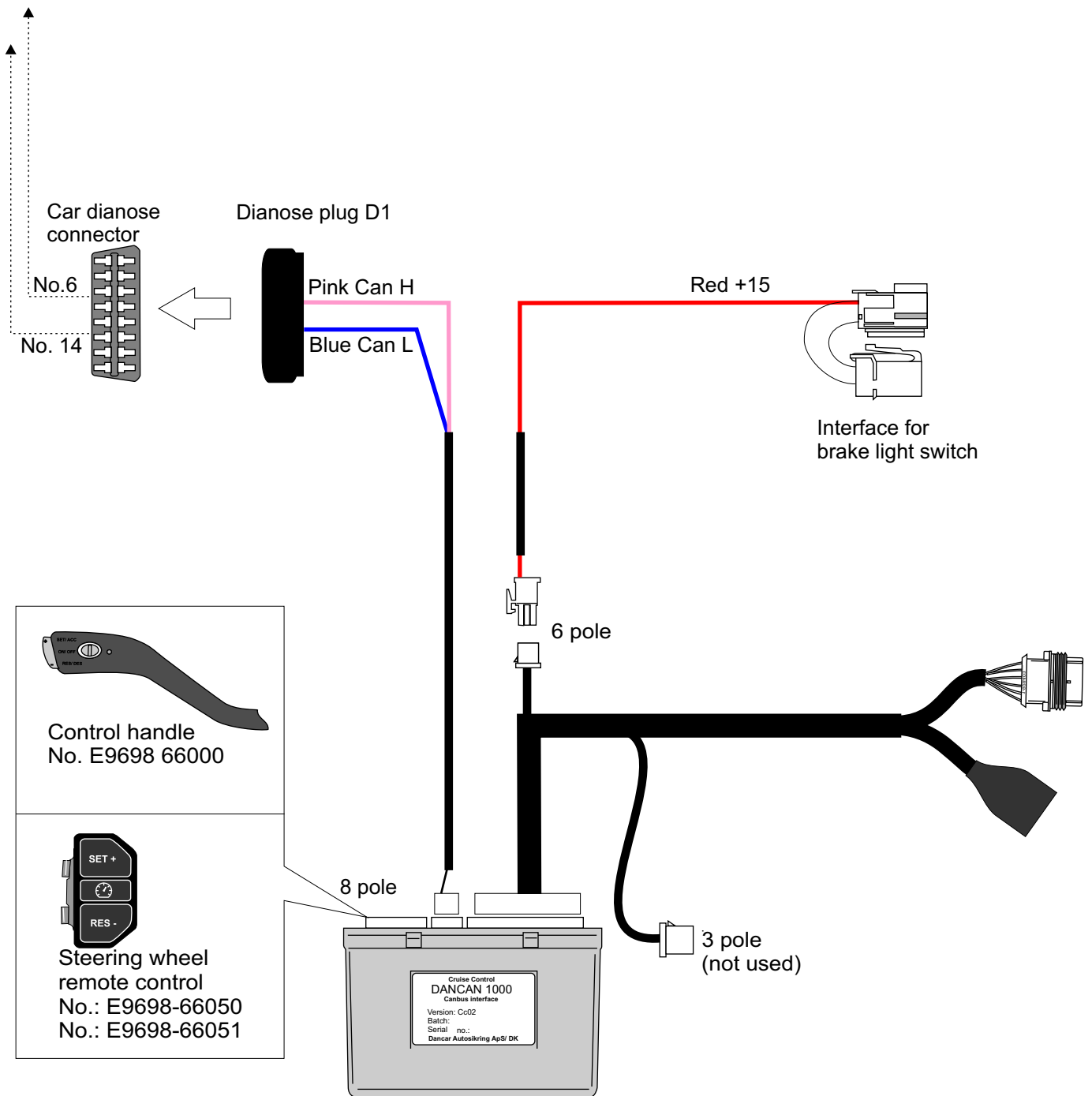

Note

SERVICE OF THE CAR

Access to the car dianose connector, can be done by temporarily removal of the D1 dianose plug.

DATA

Technical information:

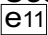
Consumption	20 mAh
Dimensions:	82X53X27
Weight:	57 g.
Supply:	12 v. dc
Marking:	E11 marking
Patent:	
TÜV/KBA:	90989
User instruction:	Seperat
	
10R-023610 Part No. 01T-063338	

NOTES

